

Lighting side

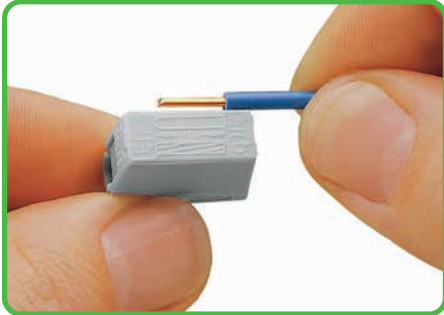

Strip conductor to 9 - 11 mm.

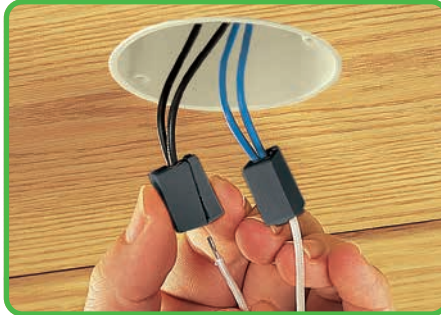

To connect: Press button fully and insert stripped conductor into square entry until it hits backstop and release.

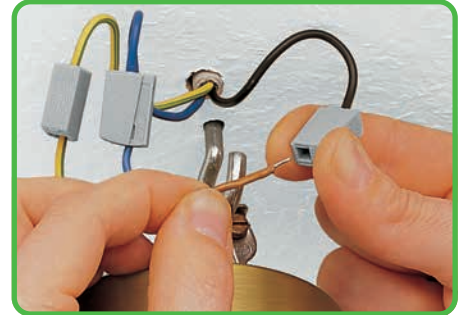

To remove: Press button and withdraw conductor.

CAGE CLAMP® clamps the following copper conductors: *

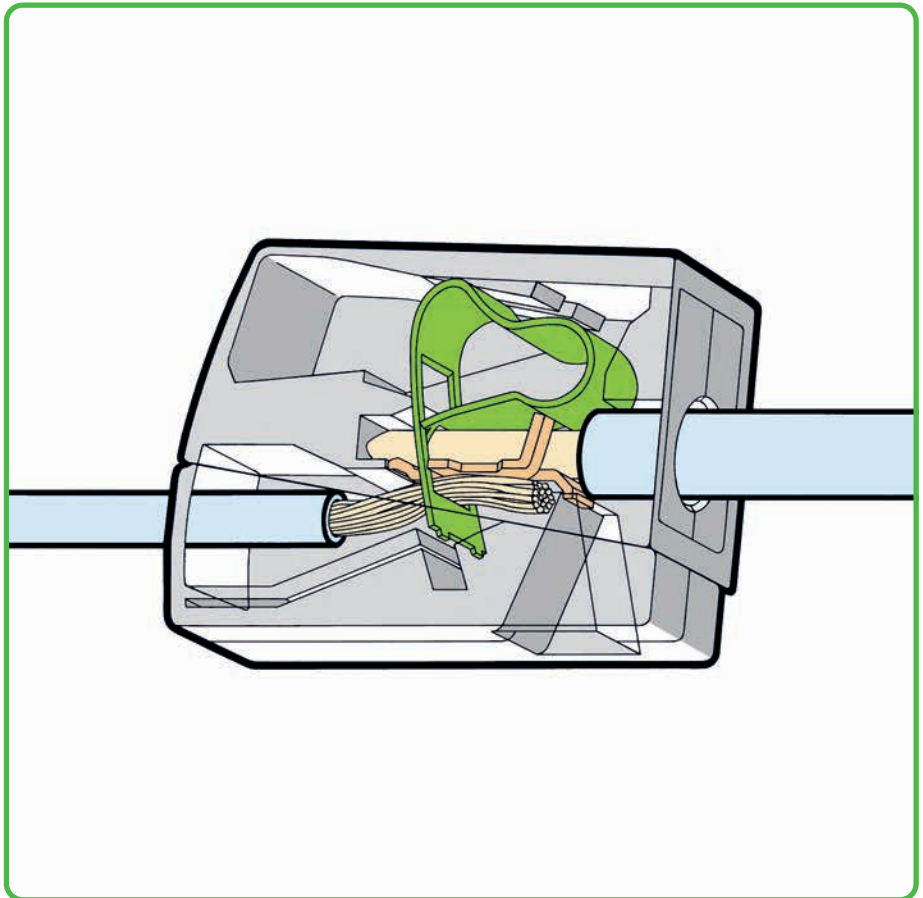

Installation side



To connect: Insert stripped solid conductor into circular entry and push until it hits the backstop.

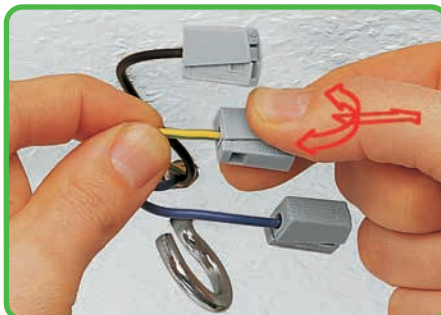

To remove: Hold conductor to be removed and twist alternately left and right while pulling the connector.



Testing through separate test slot.



PUSH WIRE®
clamps the following
copper conductors: *

solid

* Use contact paste
"Alu-Plus" when
connecting aluminum
conductors
Item No. 249-130

