

GU10/MR16 Inground Uplight

Supplied Less Lamp

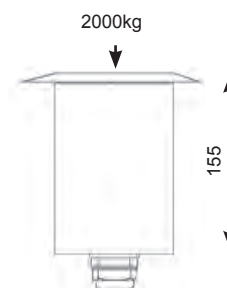

- Supplied with both MR16 and GU10 lampholders
- Compact inground uplight which accepts 12V and mains halogen, CFL and LED lamps
- Housing in die-cast aluminium with clear toughened glass diffuser of 10mm thickness
- 316 stainless steel top ring and stainless steel allen key screws
- Suitable for light vehicular traffic with a static impact resistance of up to 2000kgs
- Supplied with recessed sleeve in high resistant thermoplastic

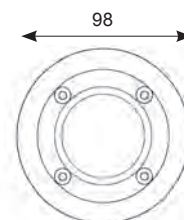

Caution: surface glass temperature will get very hot under normal halogen operation. It is recommended to use GU10 LED lamps for cooler operation.

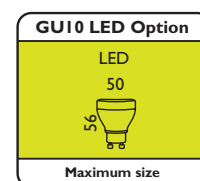

Code	Lamp	Description
AWO50	GU10/MR16	50W

