

## ½ round Clip-Over Accessories - for 20x10mm, 30x15mm and 50x25mm only

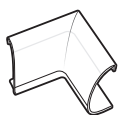

### Internal Bend

Join lengths around 90 degree inside corners.



### External Bend

Join lengths around 90 degree outside corners.

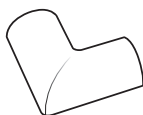

### Flat Bend

Change direction by 90 degrees on flat surfaces.



### Equal Tee

Use to join 3 lengths of same profile.

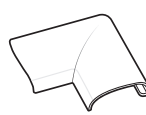

### Door Top Bend

Change direction by 90 degrees around frame tops.



### Box Adaptor Tee

For use with D-Line Surface Socket Boxes. 50x25mm only

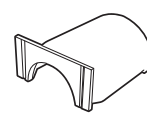

### Flat Adaptor

Connect Mini Trunking to flat surfaces 30x15mm only

## ¼ round Clip-Over Accessories - For 22x22mm only



### Internal Bend

Join lengths around 90 degree inside corners.



### External Bend

Join lengths around 90 degree outside corners.



### Cable Inlet/Outlet

Use to provide cable entry/exit point between 2 lengths.

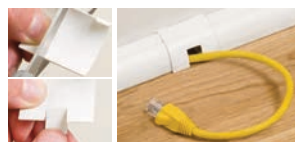

Use with Smooth-Fit Couplers & End Caps

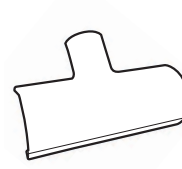

### Reducing Tee

Connect 2x 50x25mm lengths to 1x 30x15mm length.



### Skirting Tee

Connect 1x 50x25mm length to 2 x 30x15mm lengths.

## ½ round Smooth-Fit Accessories

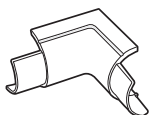

### Internal Bend

Join lengths around 90 degree inside corners.

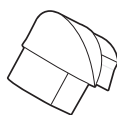

### External Bend

Join lengths around 90 degree outside corners.

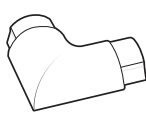

### Flat Bend

Change direction by 90 degrees on flat surfaces.

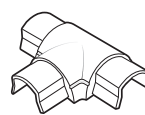

### Equal Tee

Use to join 3 lengths of same profile.

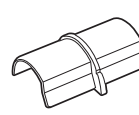

### Coupler

Join 2 lengths of same profile on flat surface.

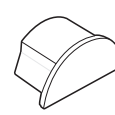

### End Cap

Neatly finish open ends.

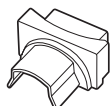

### Pattress Adaptor

Connect Mini Trunking to round surface pattresses. 30x15mm only

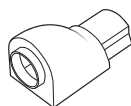

### Circular Adaptor

Connect Mini Trunking to flat edge surfaces with 20mm Ø knock-outs. 30x15mm only

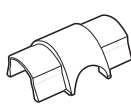

### Cable Inlet/Outlet

Takes cables in or out of a Mini Trunking. Use between lengths on straight runs. 30x15mm only

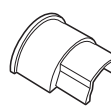

### Box Adaptor

For use with D-Line Surface Socket Boxes. 30x15mm only

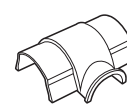

### Box Adaptor Tee

For use with D-Line Surface Socket Boxes.

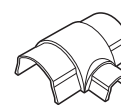

### Reducing Tee

Connect to 30 x 15mm Mini Trunking.

## ¼ round Smooth-Fit Accessories



### Internal Bend

Join lengths around 90 degree inside corners.

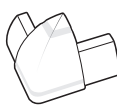

### External Bend

Join lengths around 90 degree outside corners.

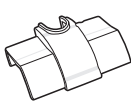

### Cable Inlet

Use to provide cable entry point between 2 lengths.

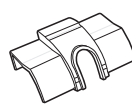

### Cable Outlet

Use to provide cable exit point between 2 lengths.

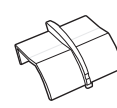

### Coupler

Joins 2 lengths on flat surfaces.

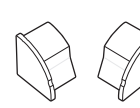

### End Cap

Neatly finish open ends (left & right versions apply).

## Other Accessories

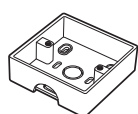

### Single Surface Socket Box

For use with 30 x 15mm, 40 x 20mm & 50 x 25mm Trunking. Available in 28mm & 35mm depth.

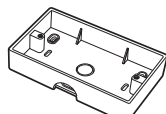

### Twin Surface Socket Box

For use with 30 x 15mm, 40 x 20mm & 50 x 25mm Trunking. Available in 28mm & 35mm depth.

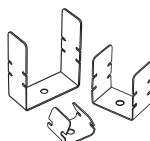

### Safe-D U-Clips

Fire rated U-shaped clips for use with D-Line and traditional trunkings. Safe-D Red version also available.

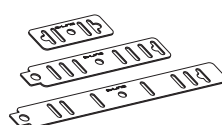

### Safe-D F-Clips

Fire rated flat, foldable, flexible cable clips for use with D-Line and traditional trunkings, as well as direct to surface installations.



### Safe-D Spring

Effectively secures single cables (<7mm o/d), either direct to surface or in PVC micro trunkings.

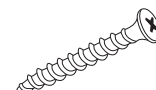

### Safe-D D-Fixing

Use for securing D-Line fire-rated Safe-D ranges & other equipment in popular substrates

## Product Specification - Clip-Over Accessories

<b>Rear Grip Tabs</b>	<ul style="list-style-type: none"><li>Secure the accessory in 1 mm gap between flat surface and D-Line length, as made possible by depth of rear foam-tape</li></ul>
<b>ABS material</b>	<ul style="list-style-type: none"><li>Robust material</li></ul>
<b>Can be painted</b>	<ul style="list-style-type: none"><li>Scuff using gentle abrasive such as fine sandpaper, so paint keys for best results</li></ul>
<b>Easy-to-install</b>	<ul style="list-style-type: none"><li>Clip-Over style can forgive poor cuts at length ends, and imprecise measuring</li></ul>

## Clip-Over Accessories - for ½-round 20x10mm, 30x15mm, 50x25mm profiles & 22x22mm ¼-round only

Design forgives rough or oblique cuts, and imprecise measuring.



## Product Specification - Smooth-Fit Accessories

<b>Internal shoulders</b>	<ul style="list-style-type: none"><li>Enables smooth appearance along installation</li><li>Creates secure fitment - will not drop off</li><li>Enable smooth flush alignment between lengths for perfect finish</li></ul>
<b>ABS material</b>	<ul style="list-style-type: none"><li>Robust material</li><li>Can be modified for fitment on uneven surfaces</li></ul>
<b>Can be painted</b>	<ul style="list-style-type: none"><li>Scuff using gentle abrasive such as fine sandpaper, so paint keys for best results</li></ul>

## Smooth-Fit Accessories - for ½-round 16x8mm, 40x20mm, 60x30mm, & 30x30mm ¼-round profiles Also available for 30x15mm, 50x25mm ½-round, & 22x22mm ¼-round profiles

Internal shoulders fit securely under lengths.

