

INSTALLATION AND USER INSTRUCTIONS - TAP SETS

IMPORTANT: THE INSTALLER MUST CONFIRM EARTH CONTINUITY ON ALL TAPS.

FIG ONE: TAP RANGE

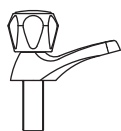
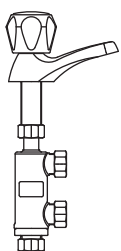
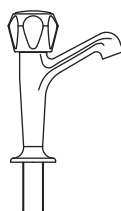
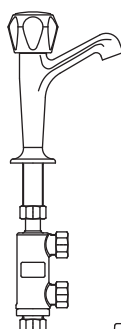
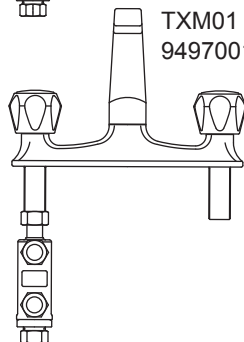
TXU01
94970017TXH01
94970014TXU02
94970018TXH02
94970015TXM01
94970016

FIG TWO: ASSEMBLY

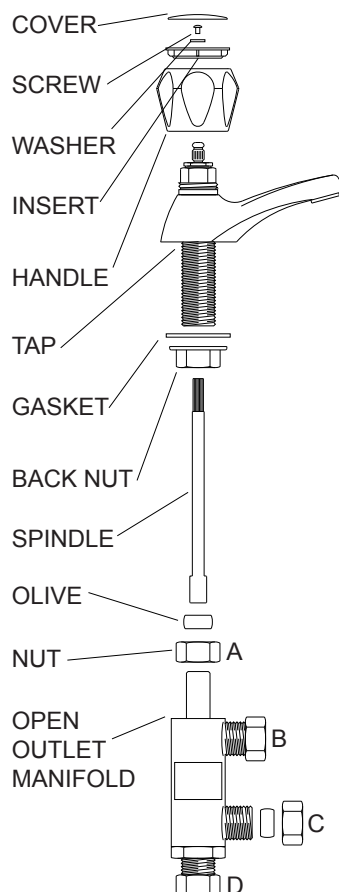


Figure Two shows assembly of the major components for TXH01. Assembly is similar for all tap sets. The open outlet manifold is always connected to the hot tap.

1. Install the tap into sink ensuring that the gasket is fitted between the tap body and mounting surface. Secure the tap in place with the backnut.
2. Fit the open outlet manifold to the hot tap. Ensure that the spindle is securely located at the top to the tap headwork and bottom to the manifold. Secure the manifold in place by tightening compression nut A (Figure Two) .
3. Compression nut B of the open outlet manifold is connected to the hot outlet of the water heater, compression nut C to the cold inlet of the water heater, and compression nut D to the cold water mains supply. Figure Three shows a typical plumbing arrangement using TXU01 and TXH01. Other tap packs are plumbed in in a similar fashion.

The handle is held in place with a screw and washer (see Figure Two). A colour coded ring is then dropped in before pushing the chrome plated cover in to place.

Use 15mm O/D copper pipe for all connections, ensure that the fitting is supported during assembly to prevent unnecessary stress to pipework.

During heating periods expanded water will drip from the tap. This is normal, DO NOT overtighten the tap in attempting to stop dripping as this will damage the tap washer.

FIG THREE: PLUMBING

