

REPLACEMENT BATTERY TYPE:

LEDREM3: 3.6V 1500mAh 3 x C Cells.
LEDMDDEM3: 4.8V 600mAh Ni-Cd batteries.

BATTERY REPLACEMENT:

If after routine operation check, the lamp does not remain lit for the three hour period, a new battery pack may be required.

01. Switch off the electricity at the mains.
02. Allow batteries to fully discharge then reconnect to supply and allow to charge for 24 hours.
03. Test again for 3 hours, if light does not remain lit change the battery pack as follows:
04. Remove the diffuser.
05. Remove the two screws indicated on the gear tray and open the fitting.
06. Unplug the battery lead from the circuit board.
07. Remove the two screws in the top of the gear tray that secure the battery pack in place and lift the battery pack out of the fitting.
08. Write current date on the new battery pack.
09. Fit new battery pack securing in place using the screws removed from the old pack.
10. Plug battery pack into circuit board.
11. Close and secure gear tray.
12. Replace diffuser.
13. Restore power and allow to charge for 24 hours.
14. Perform full operation check and update test record.

LEDREM3 SPECIFICATIONS:

Nominal lumens: 162.3 lm
Rated wattage: 5.20W
Average rated hours: 18,000 hrs
Colour temp: 6500K
Voltage: 240V
BLF / EBLF: 0.92 / 0.67

LEDMDDEM3 SPECIFICATIONS:

Rated wattage: 3.5W
Average rated hours: 18,000 hrs
Colour temp: 6500K
Voltage: 240V
BLF / EBLF: 0.92 / 0.67
Viewing distance: 32m

EVENTUALLY, YOU MAY WANT TO REPLACE THIS PRODUCT:

Regulations require the recycling of Waste from Electrical and Electronic Equipment (European "WEEE Directive" effective August 2005—UK WEEE Regulations effective 2nd January 2007). Environment Agency Registered Producer: WEE/GA0248QZ.

WHEN YOUR PRODUCT COMES TO THE END OF ITS LIFE OR YOU CHOOSE TO REPLACE IT, PLEASE RECYCLE IT WHERE FACILITIES EXIST - DO NOT DISPOSE WITH HOUSEHOLD WASTE.

INDUSTRIAL BATTERIES:

Within certain products Eterna Lighting Ltd places lead acid, lithium ion, nickel cadmium & nickel metal hydride batteries on the market. Industrial batteries are subject to waste regulation under the Waste Batteries and Accumulators Regulations 2009 and should be disposed of responsibly. Purchasers may be able to dispose of their waste industrial batteries locally via legitimate licensed trade waste contractors. Eterna is obliged to take back, free of charge and within a reasonable time, waste industrial batteries of the same chemistry supplied to a Purchaser, for treatment and recycling and is required to do this in any calendar year new industrial batteries are placed on the market. In certain circumstances, this may include batteries not originally supplied by Eterna. If any Purchaser requires Eterna to take back Industrial batteries, they should write to the Operations Director, Eterna Lighting Ltd, Huxley Close, NN8 6AB, who will then advise on the necessary arrangements for the receipt, proper treatment and recycling of, the waste industrial batteries.

CLEANING:

Clean this fitting only with a soft dry cloth.
Do not use any chemical or abrasive cleaners.

LAMP REPLACEMENT:

LED lamp - no replacement required

IF YOU EXPERIENCE PROBLEMS:

If you believe your product is defective, please return it to the place where you bought it. Our Technical Team will gladly advise on any Eterna Lighting product, but may not be able to give specific instructions regarding individual installations.

For breakage information visit: www.eterna-lighting.co.uk



INSTALLATION INSTRUCTIONS

A guide for qualified electricians

3 HOURS DURATION IN EMERGENCY MODE

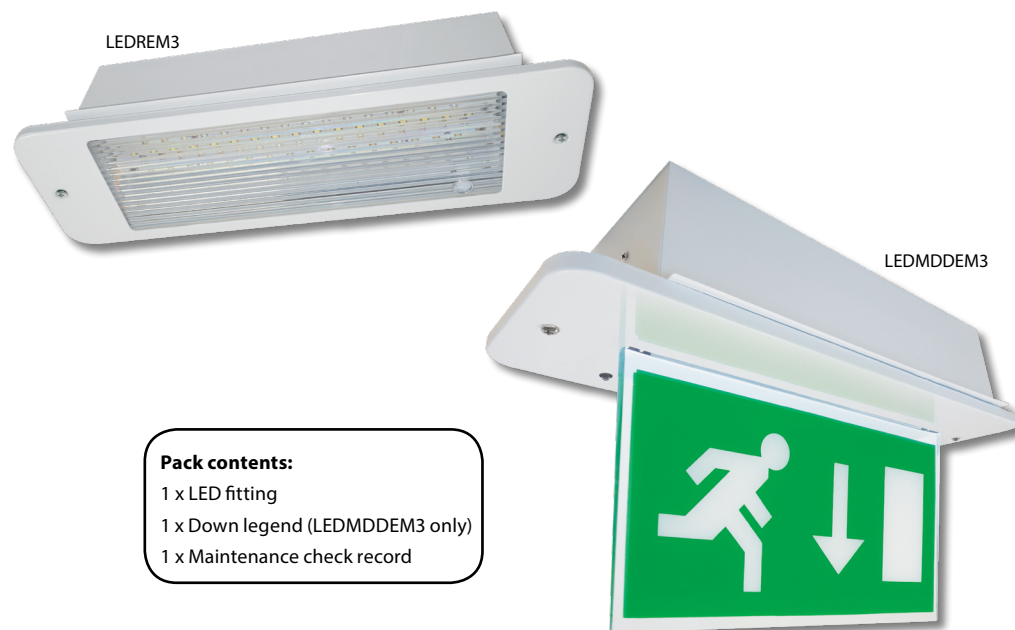

Pack contents:

- 1 x LED fitting
- 1 x Down Legend (LEDMDDEM3 only)
- 1 x Maintenance check record

Model:

LEDREM3 / LEDMDDEM3

LED Maintained Recessed Emergency Fittings

These instructions are provided as a guideline to assist you.

**PLEASE READ THESE INSTRUCTIONS BEFORE INSTALLATION
AND RETAIN FOR FUTURE REFERENCE**

Email: sales@eterna-lighting.co.uk / technical@eterna-lighting.co.uk

Visit our website: www.eterna-lighting.co.uk

Made in China

READ THIS FIRST:

Check the pack and make sure you have all of the parts listed on the front of this booklet. If not, contact the outlet where you bought this product.

This light fitting must be installed by a competent person in accordance with the Building Regulations making reference to the current edition of the IEE Wiring Regulations (BS7671).

As the buyer, installer and/or user of this product it is your own responsibility to ensure that this fitting is fit for the purpose for which you have intended it. Eterna Lighting cannot accept any liability for loss, damage or premature failure resulting from inappropriate use.

This product is designed and constructed according to the principles of the appropriate British Standard and is intended for normal service. Use of this fitting in any other environment, for example in higher than normal ambient temperatures, may result in a foreshortened working life.

The batteries supplied with this fitting are consumable parts and therefore may be outside of any warranty offered.

Switch off the mains before commencing installation and remove the appropriate circuit fuse.

When working at heights, please use a suitable platform.

Suitable for indoor use only.

This product is suitable for installation on surfaces with normal flammability e.g. wood, plasterboard, masonry. It is not suitable for use on highly flammable surfaces (e.g. polystyrene, textiles).

This product is suitable for mounting in plasterboard ceilings, suspended ceilings* and similar board surfaces. *Check specification of ceiling for suitability.

Before making fixing hole(s), check that there are no obstructions hidden beneath the mounting surface such as pipes or cables.

The chosen location of your new fitting should allow for the product to be securely mounted and safely connected to the mains supply (lighting circuit).

Do not attach to surfaces which are damp or freshly painted.

This product is designed for permanent connection to fixed wiring: this should be either a suitable lighting circuit (protected with a 5 or 6 Amp MCB or fuse) or a fused spur (with a 3 Amp fuse) via a fused connection unit.

Make connections to the electrical supply in accordance with the following code:

Live - Brown or Red
Neutral - Blue or Black
Earth - Green and Yellow

When making connections, ensure that the terminals are tightened securely and that no strands of wire protrude. Check that the terminals are tightened

onto the bared conductors and not onto any insulation. Wrap loose terminal blocks well with insulating tape.

This product must be connected to Earth.

You are advised at every stage of your installation to double-check any electrical connections you have made. After you have completed your installation there are electrical tests that should be carried out: these tests are specified in the Wiring Regulations (BS7671) referred to in the Building Regulations.

OPERATION CHECKS:

Periodic testing should be carried out to ensure emergency lighting is operating correctly. Interruption of the supply, causing the fitting to be energised from the battery, should be carried out by the operation of a local keyswitch or other isolation device. During this period all fittings should be examined visually to ensure that they are functioning correctly. At the end of the test period the supply shall be restored and all indicator lamps or devices checked to ensure that the normal supply has been restored.

DAILY:

Visual inspection of the battery charge LED.

EACH MONTH:

Isolate the power supply for a period sufficient to ensure that each lamp is illuminated. Endorse the test record form supplied.

ONCE EACH YEAR:

Isolate the power supply and check that the light is still illuminated after 3 hours. Endorse the test record form.

Because of the possibility of a failure of the normal lighting supply occurring shortly after a period of testing of the emergency lighting system or during the subsequent recharge period, all full duration tests shall wherever possible be undertaken preceding time of low risk to allow for battery recharge.

NOTE: please keep this instruction booklet and the test record in a safe place. A fire officer or other authorised person may want to see your record of inspection and testing.

IMPORTANT NOTES:

The ballast and control gear must be operated only within the enclosure supplied. The gear must not be operated outside of the enclosure.

The battery charging circuit and DC ballast are separated from the mains by at least basic (single layer) insulation.

When energised by a constant mains supply, the battery will be constantly charged whether or not the lamp is illuminated. On failure of the constant mains supply, the fitting will switch automatically using transistorised switching from battery charging to battery discharge powering the lamp whether or not the lamp was illuminated before the power failure. Both the mains and battery supplies incorporate fuse protection: see fitting for location and rating.

INSTALLATION:

NOTE: Wires should be stripped 13-14.5mm for best fit with the push-fit terminal block.

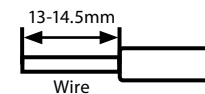

1. Undo the screws at each end of the diffuser or front plate and lift off.
2. Decide which of the cable entries you need to use and remove one of the knock-outs if necessary.
3. Cut the hole in your mounting surface using the dimensions, see Fig 1.
4. Offer the fitting up through the hole in the ceiling and allow to rest with the two large ears on the top side of your ceiling, see Fig 2.
5. Undo the screws at each end of the gear tray and allow to drop open.
6. Thread the mains supply cable in through the hole in the back of the fitting.
7. Make the electrical connections according to the colour code opposite. Take care not to leave any strands protruding from the terminals and to tighten all terminals securely. Ensure also that the terminals clamp onto the bare wire and not onto the insulation.

LEDREM3 ONLY

08. To operate the fitting in non-maintained mode, remove the link from the terminals "L" & "Lsw".
09. If the lamp is to be switched, remove the link from between the terminals marked "L" & "Lsw" and connect cables to and from your switch.

10. Mark the current date on the battery pack.
11. Connect the battery pack to the circuit board.
12. Close the gear tray and secure using the screws removed earlier, see Fig 3.
13. If you have chosen one of the drop-sign models, you need to fit the sign panel into the diffuser or slotted front plate:
 - A) Offer the top of the sign panel into the slot in the diffuser from beneath and press down on the top of the diffuser until it rests on the shoulders at the top of the panel.
 - B) Fit the small split-pins into the holes at each end of the top edge of the sign panel and bend the ends over to stop them from coming out again, see Fig 3.
14. Replace the diffuser or front plate and tighten securely making sure that the fitting is properly located around the hole in your ceiling.



NOTE: this unit has a permanent live mains supply, please ensure you isolate before removing cover.

There may also be a separate switched supply that controls the emergency light fitting - this also needs to be isolated.

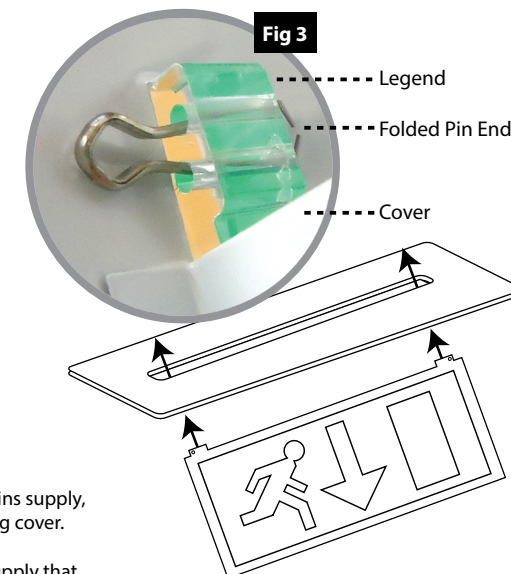
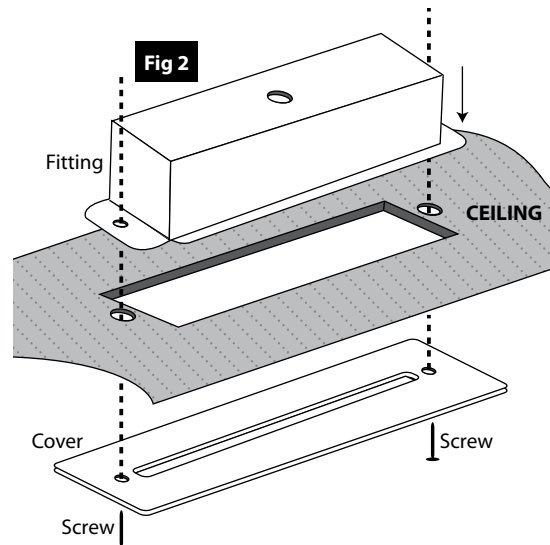
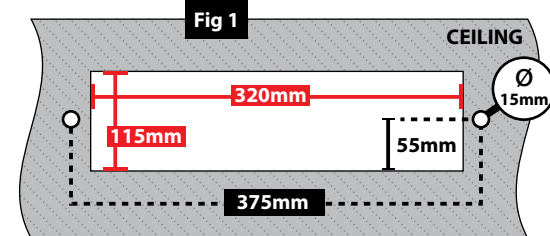



INSTALLATION, MAINTENANCE AND OPERATION CHECK RECORD

Product Description:

Installation
Date:

Installation
Test Duration:

Installed
By:

[illegible]