

SPECIFICATION DETAILS

The 220x90mm Rectangular Flat Channel Connector is manufactured from (white) High Impact Polystyrene and has a minimum free area of 18,545mm². It has a female adaptor for connection outside of the System 220 duct.

Fully compliant with SAP Appendix Q Product Characteristics Database recommendations for duct sizes used with both extract and Mechanical Heat Recovery Systems.

Manufactured in compliance with Domestic Plastic Ductwork Specification DW/154 and does meet UL94HB flammability standard.

MAX/MIN OPERATING TEMPERATURES
+ 60°C to - 15°C

Size:	220mm x 90mm
For use with:	Vortice Ducting
Box quantity:	36
Individual Weight:	132g
Colour:	White

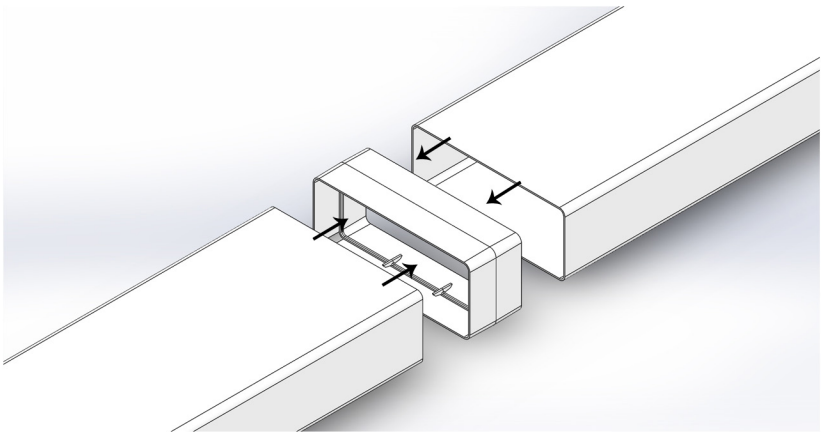

AIRFLOW	RESISTANCE
8 l/s	N/A
13 l/s	N/A
21 l/s	N/A
30 l/s	N/A
60 l/s	N/A
120 l/s	N/A