

T80Z Fast-Fit electric shower

Temperature Control	Stabilised
Power Ratings	7.5 kW, 8.5 kW, 9.5 kW, 10.5 kW
Inlet Connection	15mm compression
Water Entry Points	Top, bottom, side bottom, back (left hand side unit) Top, bottom, side bottom, back (right hand side unit)
Cable Entry Points	Top, bottom, back (left hand side unit) Top, bottom, back (right hand side unit)
Outlet Connection	1/2" BSP
Plumbing System	Cold water only
Minimum Running Pressure/Flow for full performance*	1.0 Bar @ 8 l/min 1.5 Bar @ 11 l/min for 10.5 kW*
Maximum Static Pressure	10 Bar
Surface Mounted Only	
Approvals, Complies with	BEAB, CE, BSI Kitemark
Guarantee	2 years

To see all finishes and for further details please see page 28-29.
*At running pressure/flow 0.7 Bar at 8 l/min (1.2 Bar at 11 l/min for 10.5kW)
the shower will continue to operate at a reduced performance.

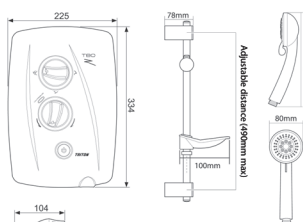

Finish	Power	Code
Chrome	8.5 kW	SP8CHR8ZFF
Chrome	9.5 kW	SP8CHR9ZFF
Chrome	10.5 kW	SP8CHR12ZFF
White/Chrome	7.5 kW	SP8007ZFF
White/Chrome	8.5 kW	SP8008ZFF
White/Chrome	9.5 kW	SP8009ZFF
White/Chrome	10.5 kW	SP8001ZFF
White/Chrome	8.5 kW	ECO8008ZFF

T80Z Thermostatic electric shower

Temperature Control	Thermostatic
Power Ratings	8.5 kW, 9.5 kW, 10.5 kW
Inlet Connection	15mm compression
Water Entry Points	Top, bottom, side bottom, back (left hand side unit) Bottom, side bottom, back (right hand side unit)
Cable Entry Points	Top, bottom, back (left hand side unit) Bottom, back (right hand side unit)
Outlet Connection	1/2" BSP
Plumbing System	Cold water only
Minimum Running Pressure/Flow for full performance*	1.0 Bar @ 8 l/min 1.5 Bar @ 11 l/min for 10.5 kW
Maximum Static Pressure	10 Bar
Surface Mounted Only	
Approvals, Complies with	BEAB, CE, BSI Kitemark
Guarantee	2 years

To see all finishes and for further details please see page 32-33.
*At running pressure/flow 0.7 Bar at 8 l/min (1.2 Bar at 11 l/min for 10.5kW)
the shower will continue to operate at a reduced performance.

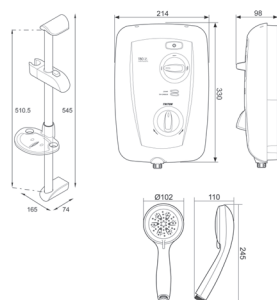

Finish	Power	Code
Chrome	9.5 kW	SP8CHR9ZTHM
Chrome	10.5 kW	SP8CHR12ZTHM
White/Chrome	8.5 kW	SP8008ZTHM
White/Chrome	9.5 kW	SP8009ZTHM

T90xr pumped electric shower

Temperature Control	Pumped Electric Stabilised
Power Ratings	8.5 kW, 9.5 kW
Inlet Connection	15mm compression
Water Entry Points	Top, bottom, back (left hand side unit)
Cable Entry Points	Top, bottom, back (left hand side unit)
Outlet Connection	1/2" BSP
Plumbing System	Cold water cistern only
Minimum Head Pressure	75mm
Maximum Head Pressure	10m
Surface Mounted Only	
Approvals, Complies with	BEAB, CE, BSI Kitemark
Guarantee	2 years

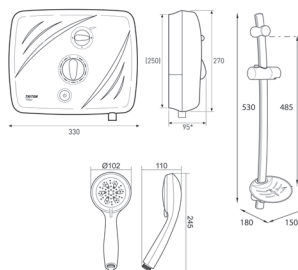

Finish	Power	Code
White/Chrome	8.5 kW	SP9008SI
White/Chrome	9.5 kW	SP9009SI

Safeguard Pumped Care thermostatic electric shower

Temperature Control	Thermostatic pumped electric
Power Ratings	8.5 kW, 9.5 kW
Inlet Connection	15mm compression
Water Entry Points	Top, bottom, back (right hand side unit)
Cable Entry Points	Top, bottom, back (right hand side unit)
Outlet Connection	1/2" BSP
Plumbing System Compatibility	Cold water cistern only
Minimum Head Pressure	75mm
Maximum Head Pressure	10m
Surface Mounted Only	
Approvals	BEAB, BEAB CARE, RNIB, CE, BSI Kitemark
Guarantee	2 years

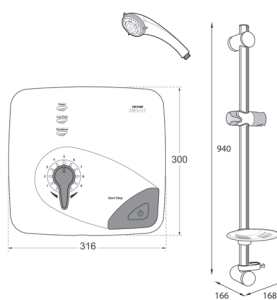

Finish	Power	Code
White/Chrome	8.5 kW	CSGPE08WC
White/Chrome	9.5 kW	CSGPE09WC

T80Z Slimline electric shower

Temperature Control	Stabilised
Power Ratings	8.5 kW, 9.5 kW, 10.5 kW
Inlet Connection	15mm compression
Water Entry Points	Top, bottom, side bottom, back (left hand side of unit) Bottom, side bottom, back (right hand side of unit)
Cable Entry Points	Top, bottom, back (left hand side of unit) Bottom, back (right hand side of unit)
Outlet Connection	1/2" BSP
Plumbing System	Cold water only
Minimum Running Pressure/Flow for full performance*	1.0 Bar @ 8 l/min 1.5 Bar @ 11 l/min for 10.5 kW
Maximum Static Pressure	10 Bar
Surface Mounted Only	
Approvals, Complies with	BEAB, CE, BSI Kitemark
Guarantee	2 years

To see all finishes and for further details please see page 30-31.
*At running pressure/flow 0.7 Bar at 8 l/min (1.2 Bar at 11 l/min for 10.5kW)
the shower will continue to operate at a reduced performance.

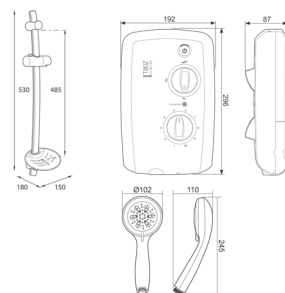

Finish	Power	Code
Chrome	9.5 kW	SP8CHR9ZSLM
Chrome	10.5 kW	SP8CHR12ZSLM
White/Chrome	8.5 kW	SP8008ZSLM
White/Chrome	9.5 kW	SP8009ZSLM
White/Chrome	10.5 kW	SP8001ZSLM
White/Chrome	8.5 kW	ECO8008ZSLM

T70Z electric shower

Temperature Control	Stabilised
Power Ratings	7.5 kW, 8.5 kW
Inlet Connection	15mm compression
Water Entry Points	Top, bottom, back (left hand side unit) Bottom, back (right hand side unit)
Cable Entry Points	Top, bottom, back (left or right hand side unit*)
Outlet Connection	1/2" BSP
Plumbing System	Cold water only
Minimum Running Pressure/Flow	1 Bar @ 8 l/min**
Maximum Static Pressure	10 Bar
Surface Mounted Only	
Approvals, Complies with	BEAB, CE, BSI Kitemark
Guarantee	2 years

*At running pressure/flow 0.7 Bar at 8 l/min the shower will continue to operate at a reduced performance.
**RHS is achieved using the Z Uni-fit Kit.

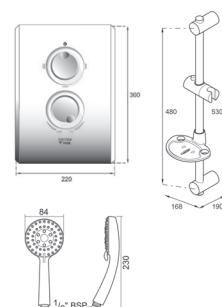

Finish	Power	Code
White	7.5 kW	SP7007Z
White	8.5 kW	SP7008Z

Safeguard Care thermostatic electric shower

Temperature Control	Thermostatic
Power Ratings	8.5 kW, 9.5 kW
Inlet Connection	15mm compression
Water Entry Points	Top, bottom, back (right hand side of unit)
Cable Entry Points	Top, bottom, back (right hand side of unit)
Outlet Connection	1/2" BSP
Plumbing System Compatibility	Mains cold water only
Minimum Running Pressure/Flow	0.5 Bar at 8l/min*
Maximum Static Pressure	10 Bar
Surface Mounted Only	
Approvals	BEAB, BEAB CARE, RNIB, CE, BSI Kitemark, WRAS
Guarantee	2 years

*Recommended minimum running pressure/flow for full performance 1 Bar @ 8 l/min

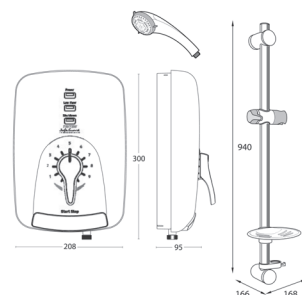

Finish	Power	Code
White/Chrome	8.5 kW	C100SG08WC
White/Chrome	9.5 kW	C100SG09WC

Elina TMV3 Exposed Concentric thermostatic mixer shower

Temperature Control	Thermostatic
Plumbing System Compatibility	Low and high pressure
Inlet Connections	15mm compression
Water Entry Points	Rising, falling, back
Outlet Connection	1/2" BSP top or bottom
Minimum Running Pressure/Flow	0.1 Bar @ 8l/min
Maximum Running Pressure	5 Bar
Maximum Static Pressure	10 Bar
Open Outlet Flowrate at 0.1 Bar	8.5l/min
Maximum Flow with Flow Limiters Fitted	12l/min
Pipe Inlet Centres	150-155mm
Approvals, Complies with	TMV3, WRAS
Guarantee	3 years

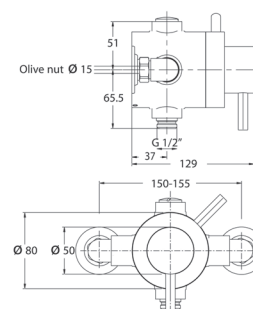

Finish	Code
Chrome	ELITMV3EXCM