

Wiring Emergency Pack R3EMPK4-PSU into Fitting with Swift

R3EMPK4-PSU & Fitting with Swift

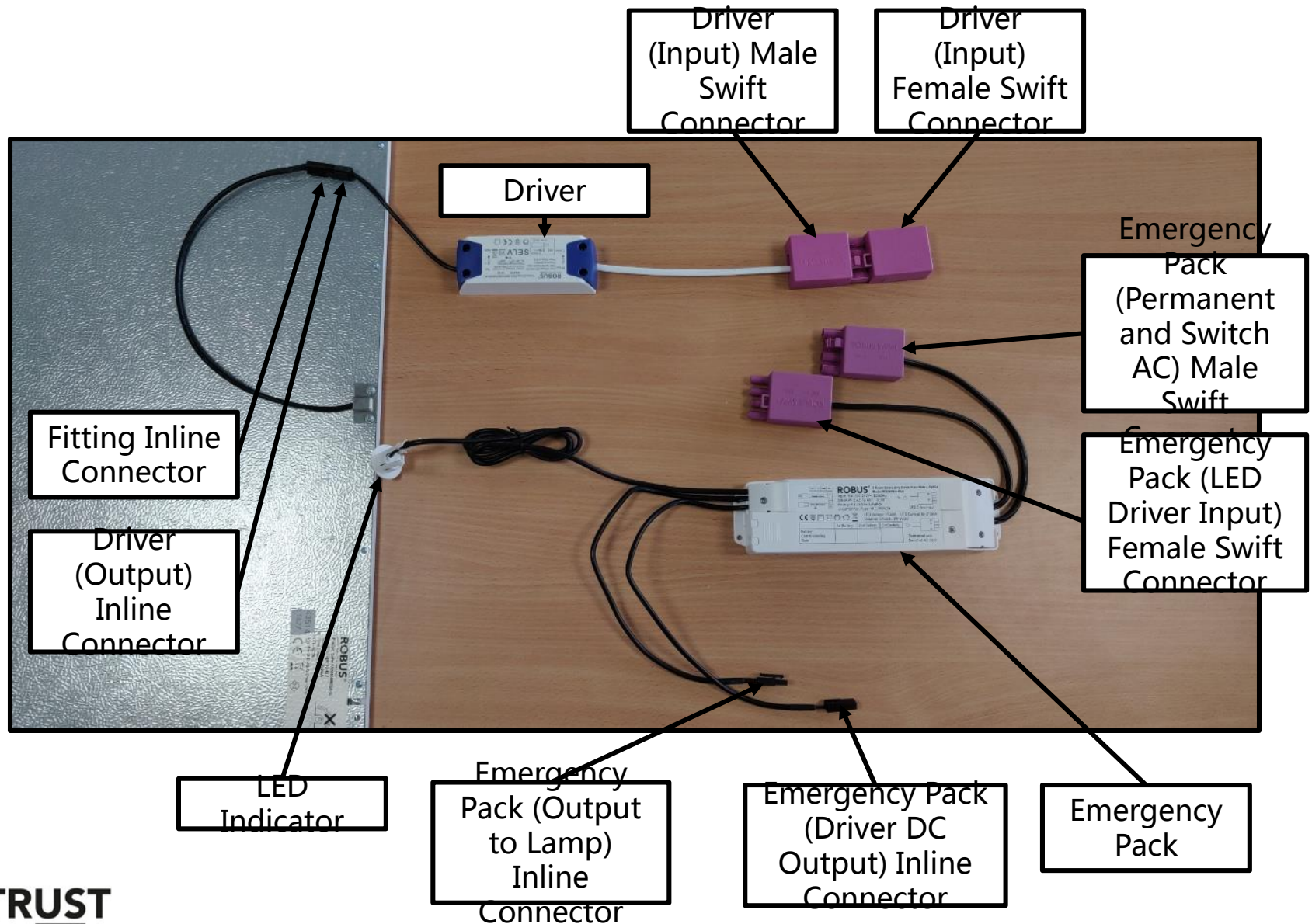

R3EMPK4-PSU & Fitting with Swift

Remove the Female Swift Connector from the Driver Input and connect it to the Male Swift Connector of the Emergency Pack labelled 'Permanent and Switch AC'.

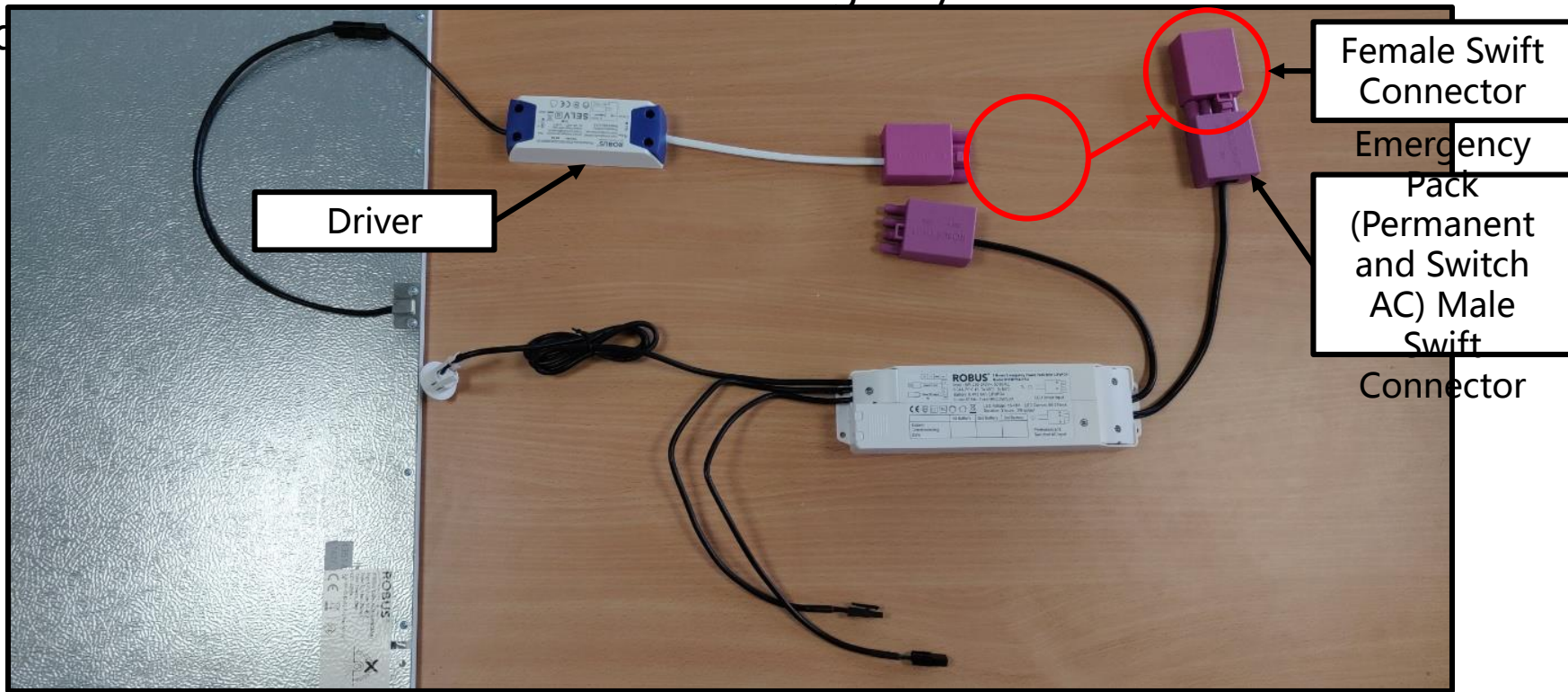

R3EMPK4-PSU & Fitting with Swift

Connect the Female Swift Connector of the Emergency Pack labelled 'LED Driver Input' to the Driver Male Swift Connector

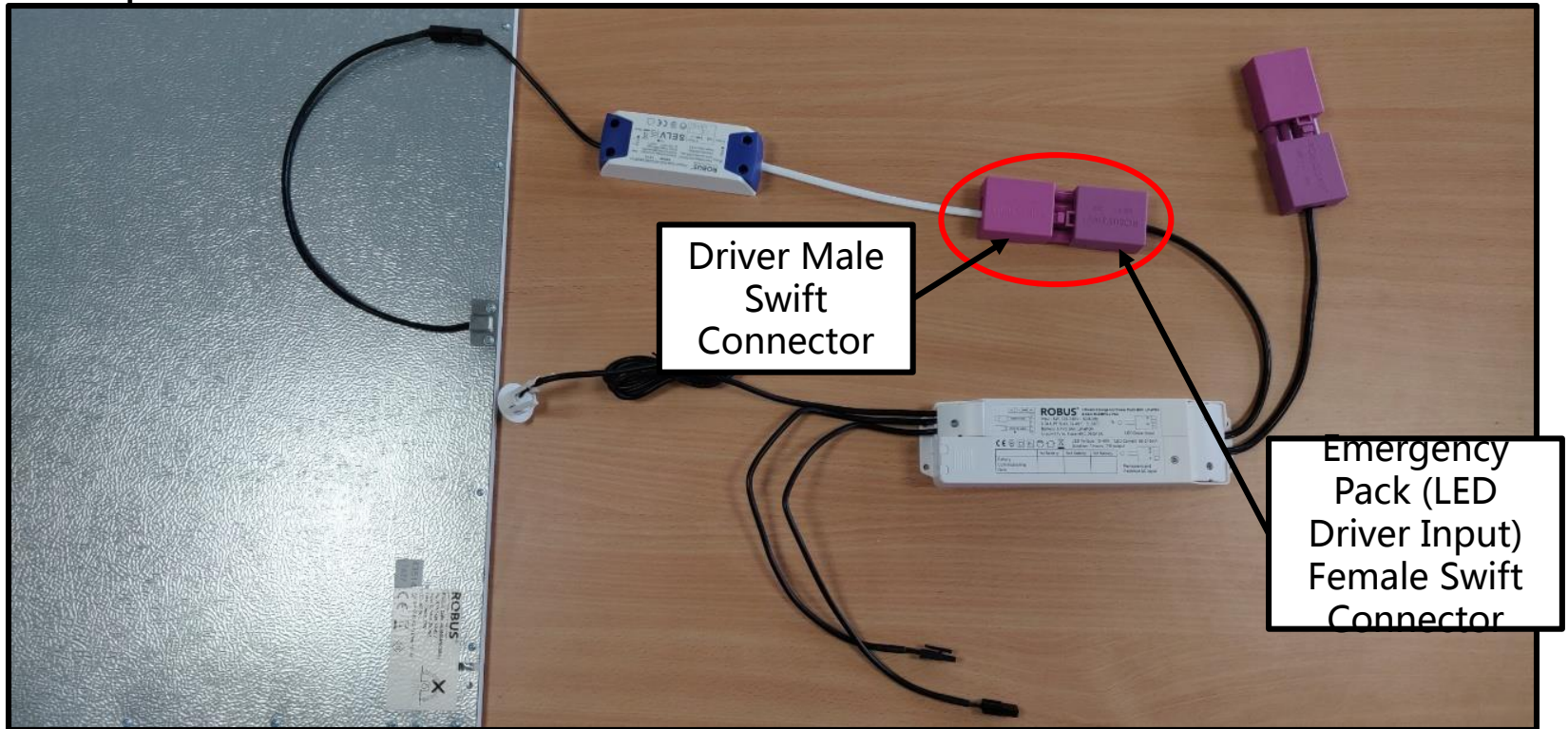

R3EMPk4-PSU & Fitting with Swift

Disconnect the Inline Connector between the Driver and the Fitting

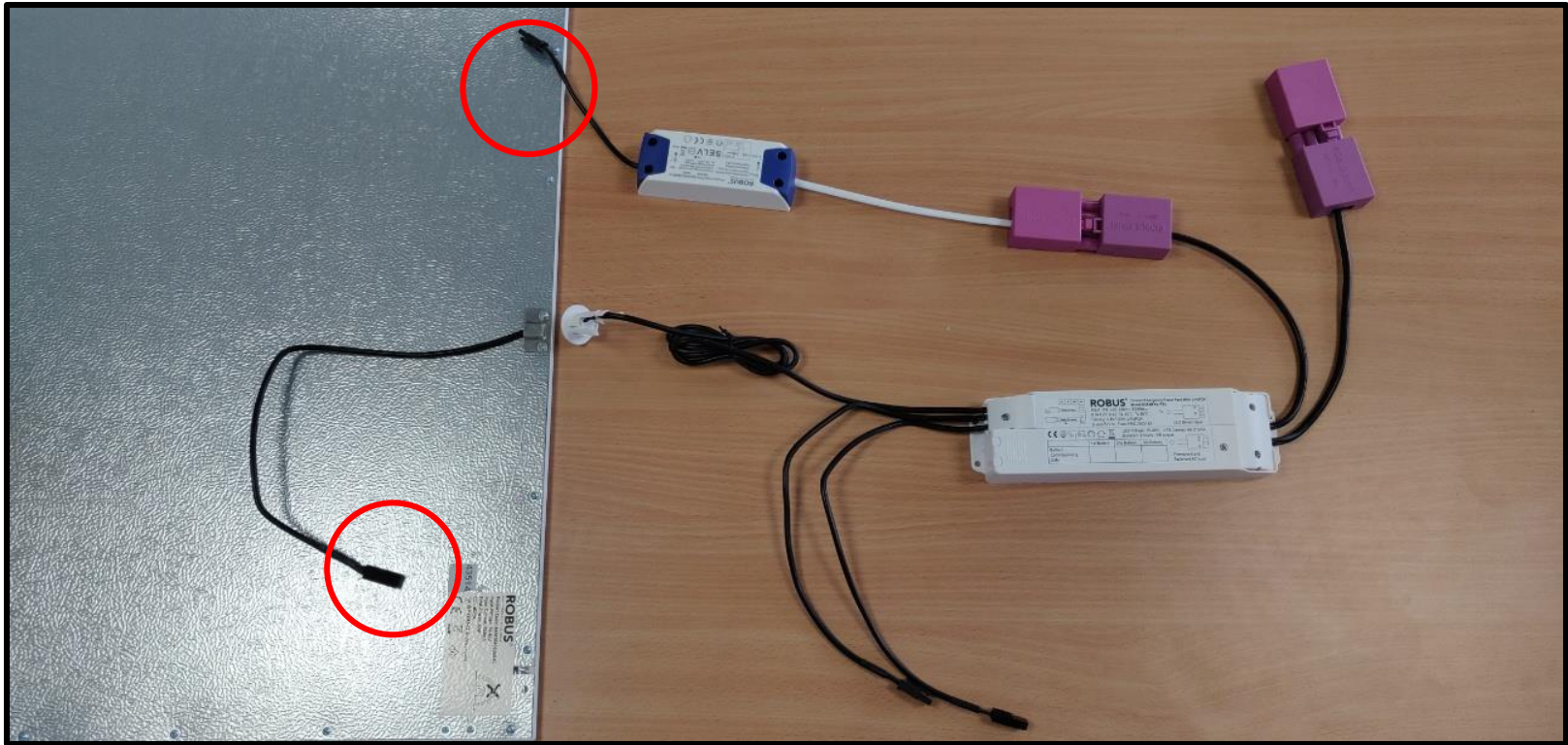

R3EMPK4-PSU & Fitting with Swift

Connect the Inline Connector of the Fitting to the Inline Connector of the Emergency Pack labelled 'Output to Lamp'

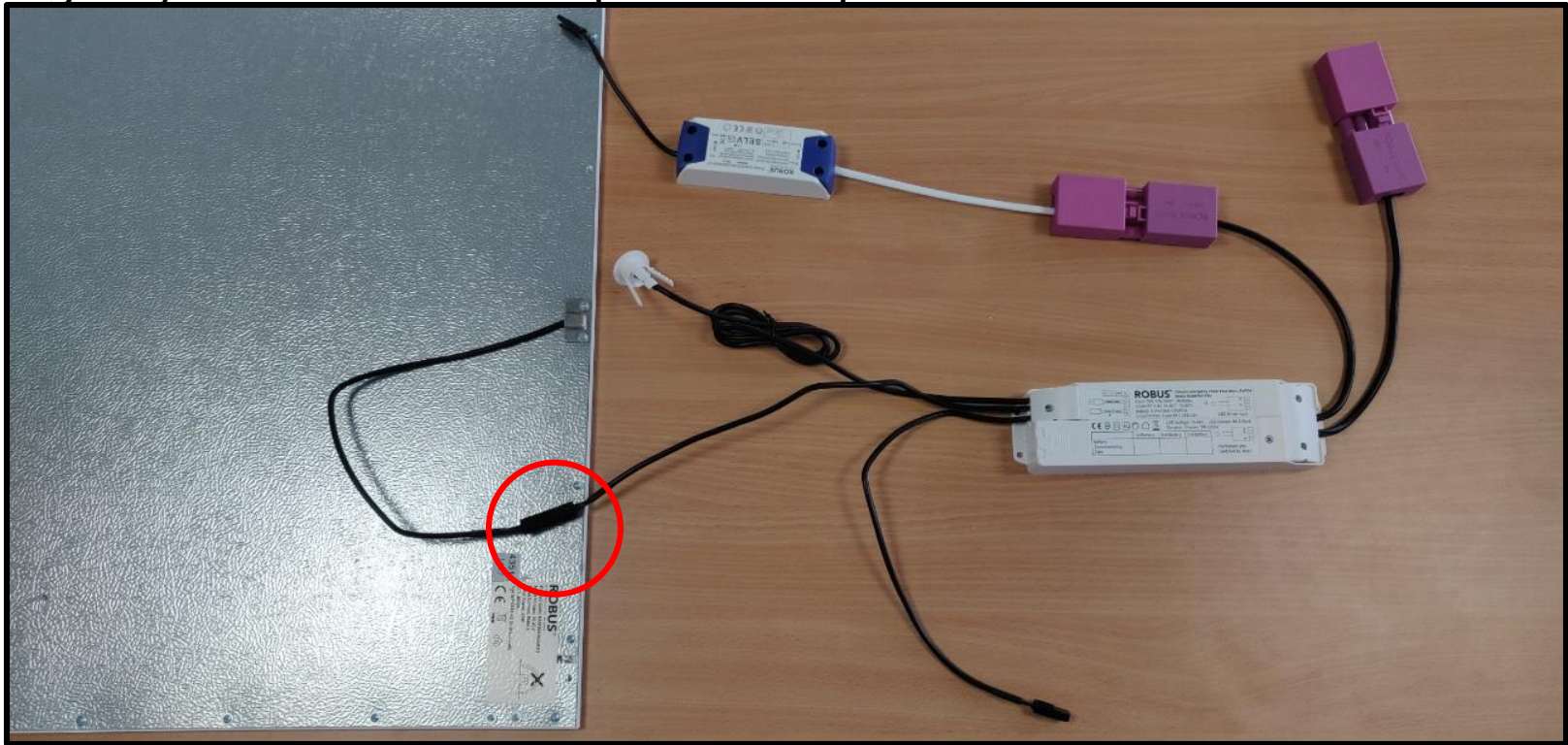

R3EMPk4-PSU & Fitting with Swift

Connect the Inline Connector of the Driver Output to the Inline Connector of the Emergency Pack Driver Output labelled 'Driver DC Output'

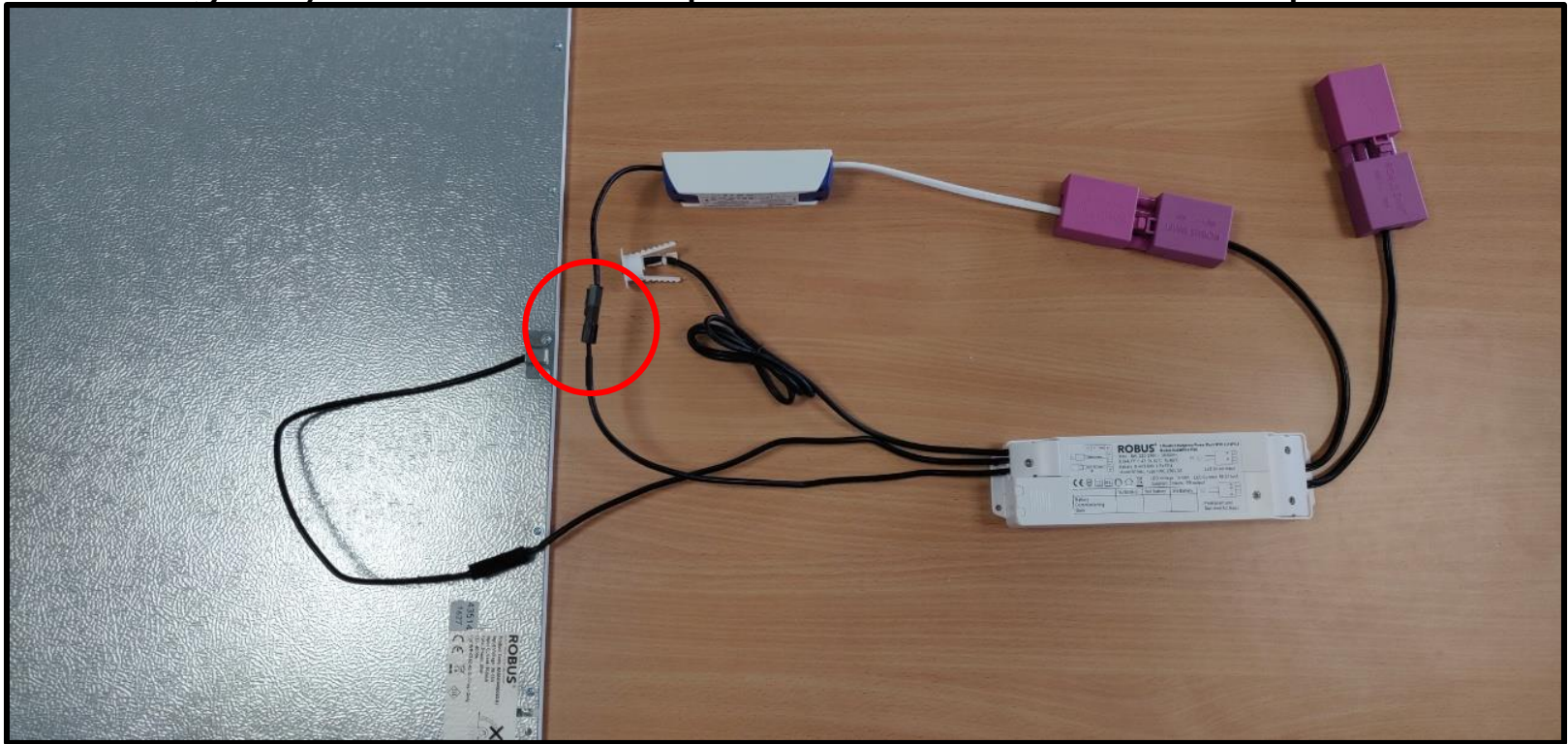

Wiring Emergency Pack R3EMPK4-PSU into Fitting without Swift

R3EMPK4-PSU & Fitting without Swift

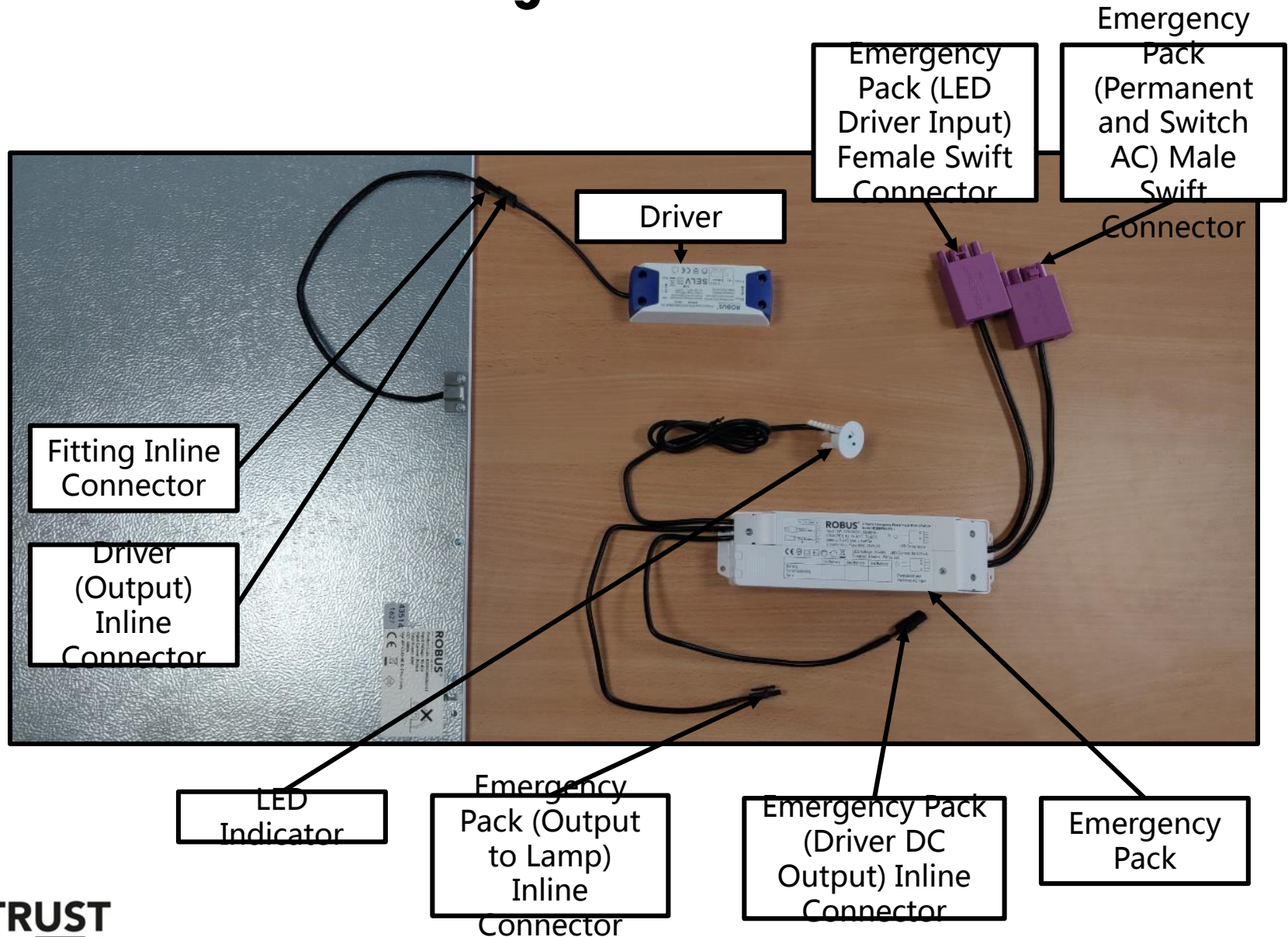

R3EMPK4-PSU & Fitting without Swift

Remove Female Swift Connector from the Emergency Pack cable labelled 'LED Driver Input'

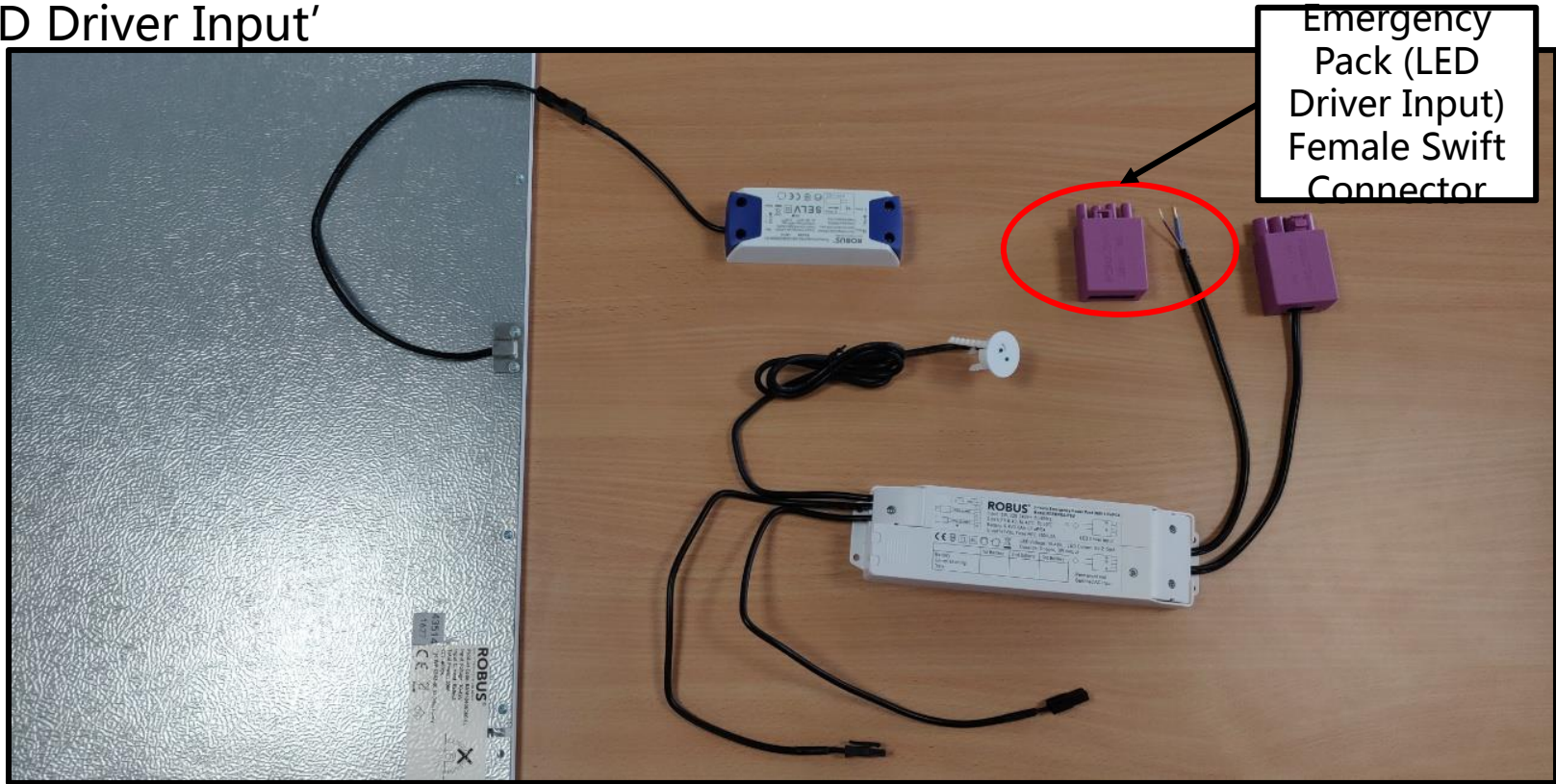

R3EMPK4-PSU & Fitting without Swift

Connect the removed Female Swift Connector to the Male Swift Connector of the Emergency Pack labelled 'Permanent and Switched AC'

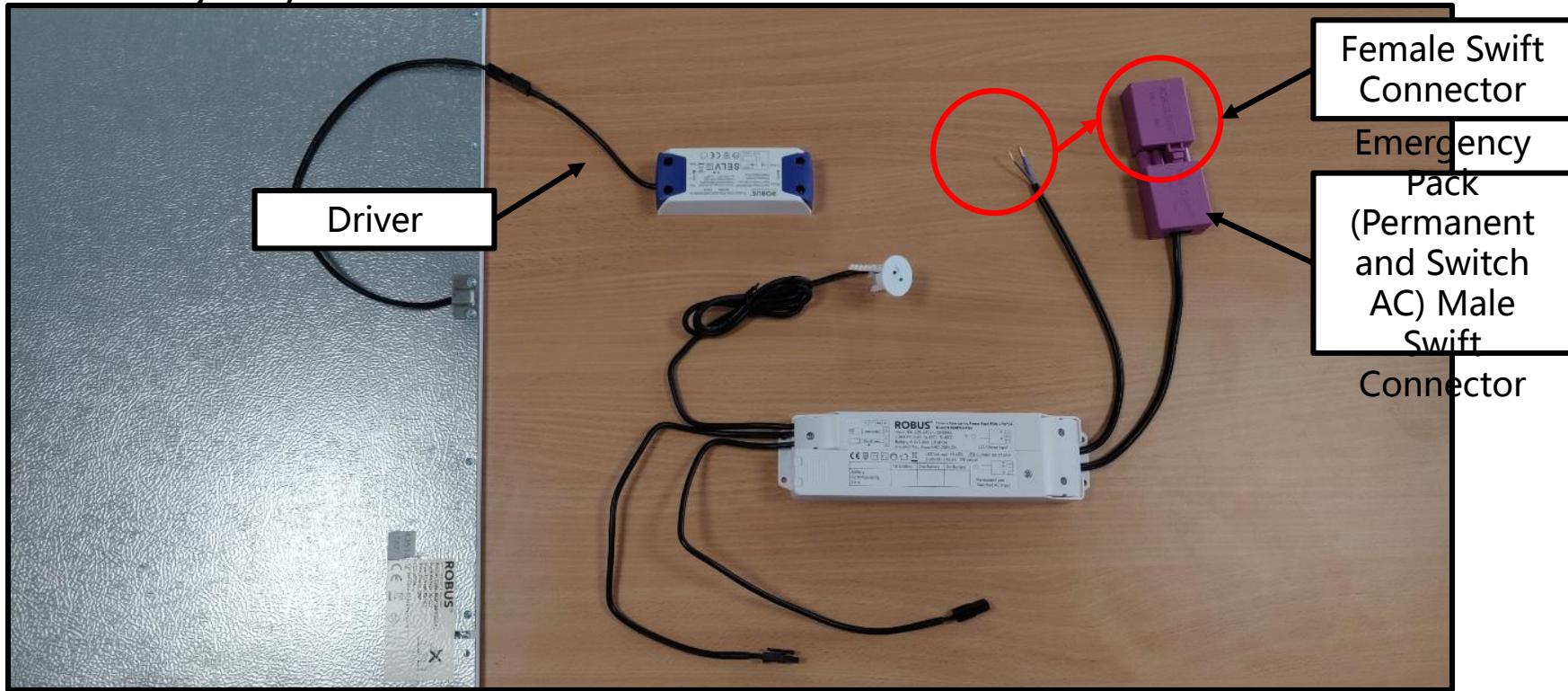

R3EMPK4-PSU & Fitting without Swift

Connect the Emergency Pack cable labelled 'LED Driver Input' to Input side of the Driver

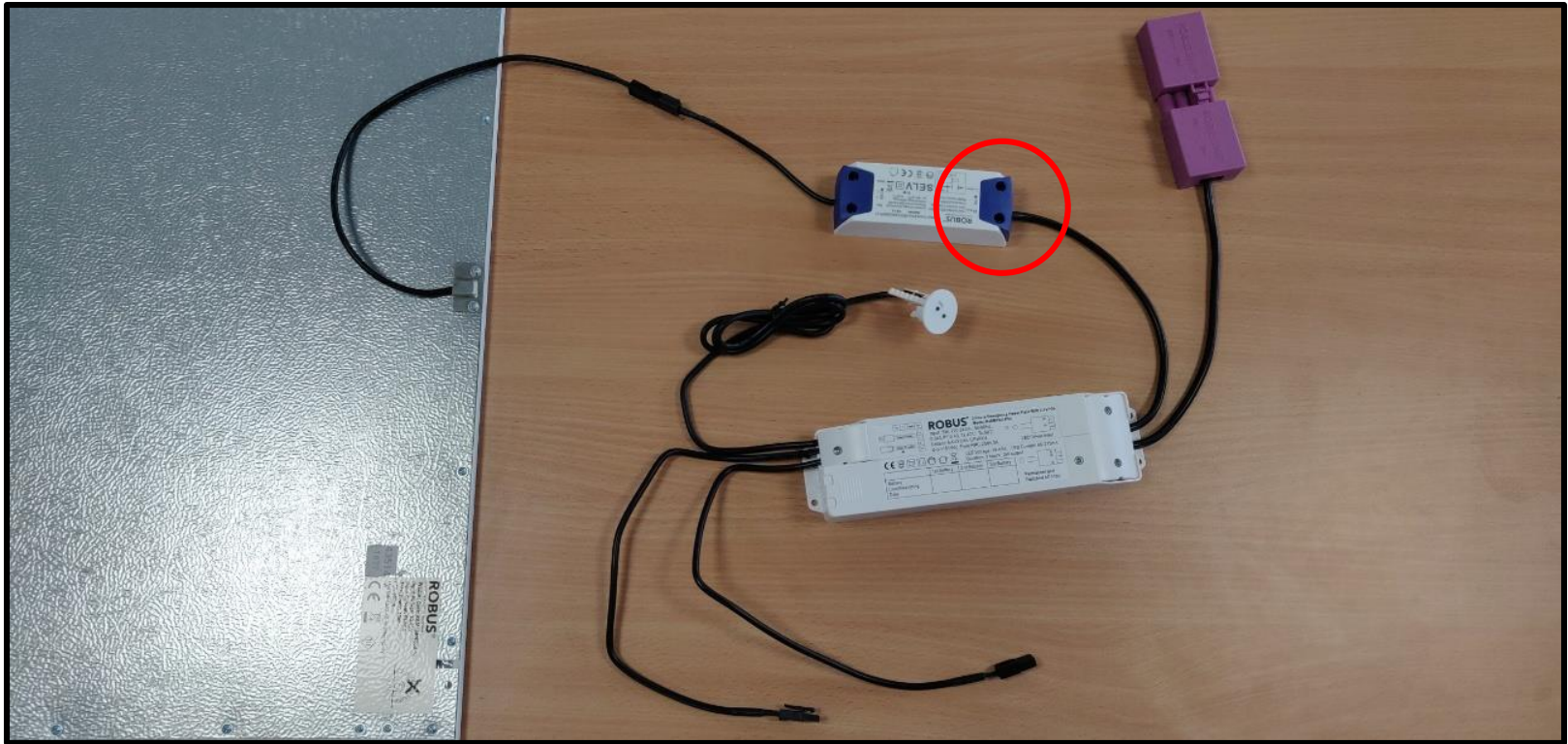

R3EMPK4-PSU & Fitting without Swift

Disconnect the Inline Connector between the Driver and the Fitting

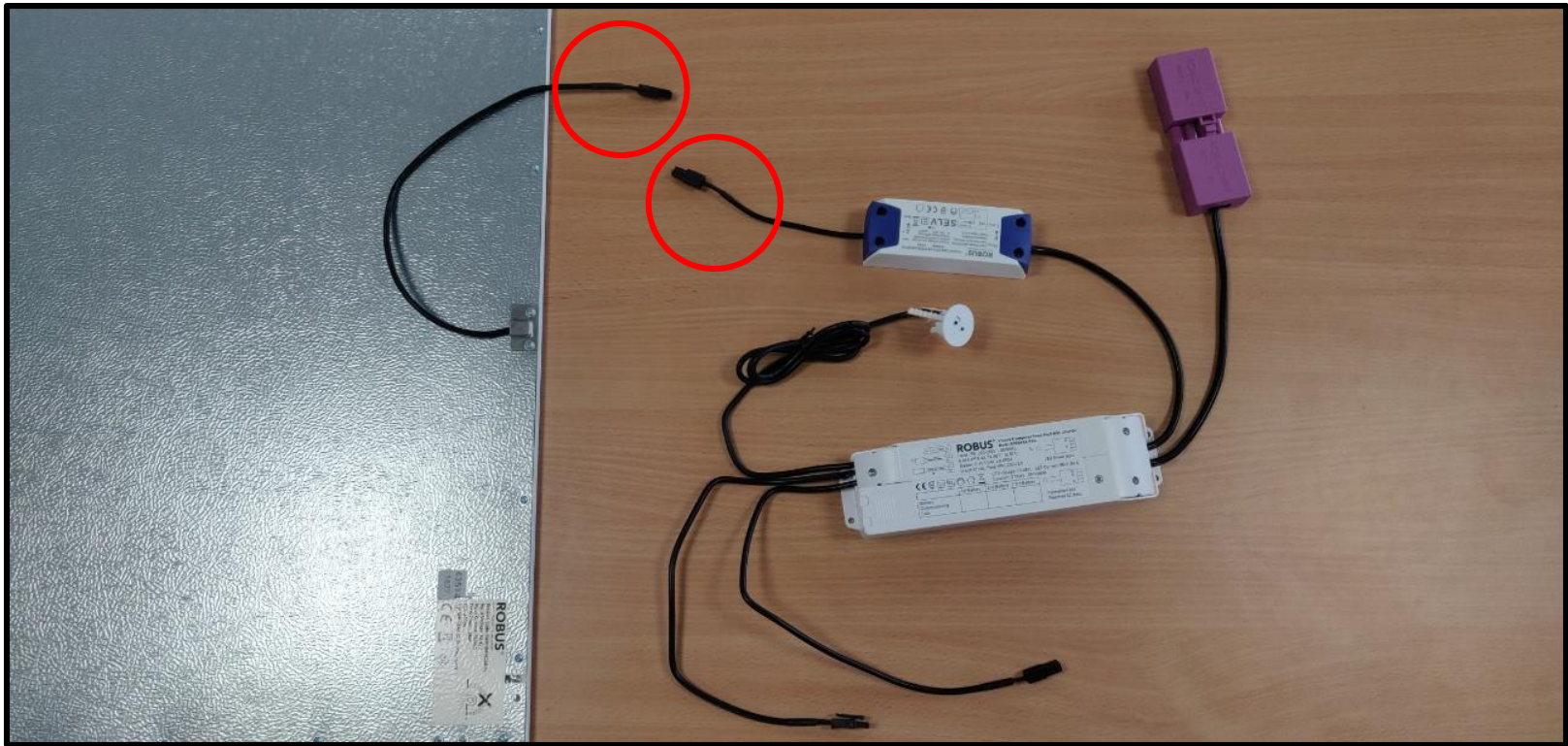

R3EMPK4-PSU & Fitting without Swift

Connect the Inline Connector of the Fitting to the Inline Connector of the Emergency Pack labelled 'Output to Lamp'

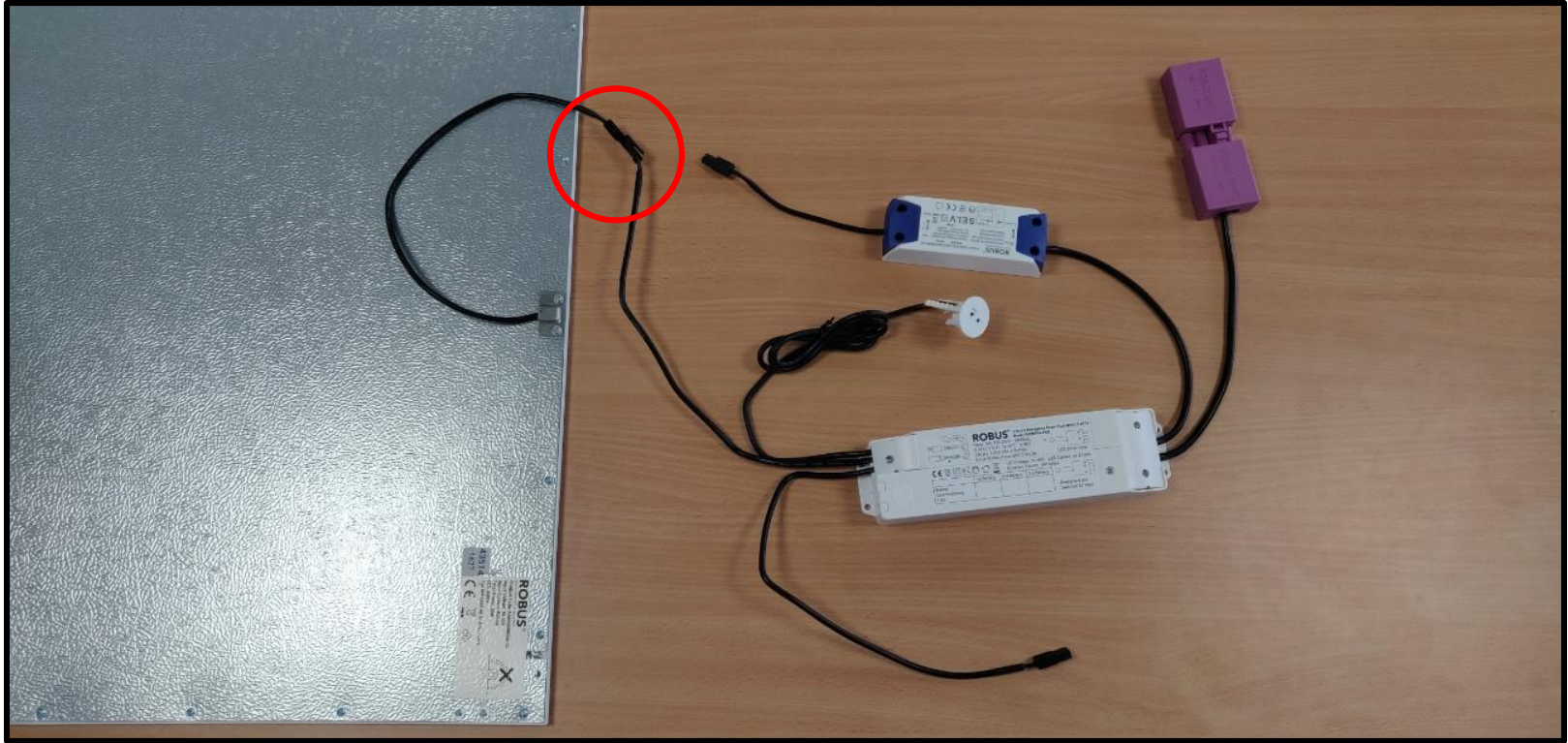

R3EMPk4-PSU & Fitting without Swift

Connect the Inline Connector of the Driver Output to the Inline Connector of the Emergency Pack Driver Output labelled 'Driver DC Output'

