

COMPACT 2 TRUNKING

Compact 2 is a small, fully segregated two compartment trunking system with a square top profile. This trunking is suited to fit within areas where physical outside dimensions are important, for example, to negotiate above or below radiators and window sills.



Product information

- 130 x 50mm
- One full size compartment and one half size
- For dado and skirting installation
- **Note:** where Compact 2 is fitted at skirting level, it is recommended that the larger compartment is installed at the top.
- Can be subdivided
- Self extinguishing and non-flame propagating PVC-U

Data information

- Compliant up to Cat 7a
- Standard bend radius 25mm
- Data fittings available for bend radius up to 50mm
- Compact 1 and 2 small compartment can be screened to assist against EMI with no reduction in cable capacity
- Adjustable data box 32-40mm
- Screened data boxes
- Steel screening divider available to BS EN 50714-2

Standard Colour
WH
WH: White

See page 65 for quick reference chart

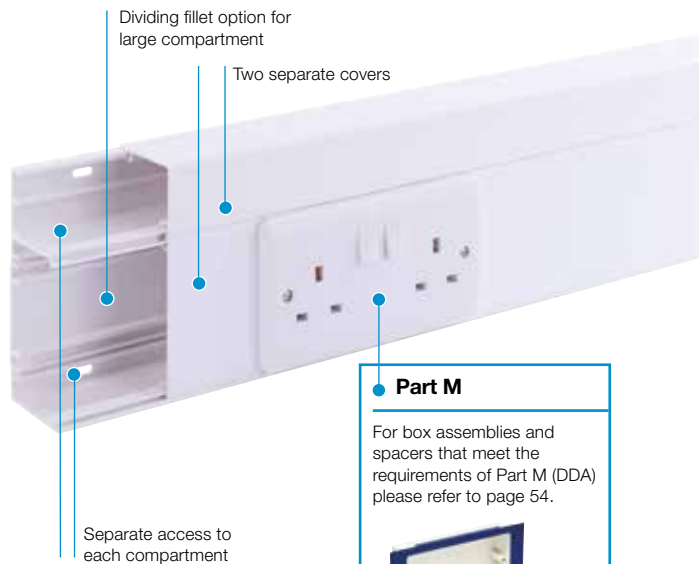

Part M

For box assemblies and spacers that meet the requirements of Part M (DDA) please refer to page 54.



Basic components



Base unit

code	description	pack
ETB2WH		4 x 3m



Main compartment cover

code	description	pack
ETL1WH		8 x 3m



Square cover

code	description	pack
ETSC1WH		8 x 3m

REASSURINGLY RECYCLED

OUR COMPACT 2 TRUNKING BUILT UP PROFILE IS MANUFACTURED USING 35% RECYCLED MATERIAL. WE ARE WORKING TO INCREASE THE LEVEL OF RECYCLED MATERIAL USED IN THIS RANGE.

Fittings



Compact 2 Couplers

code	description	pack
ECC2WH	2 piece	5



Compact 2 End caps LH & RH

code	description	pack
EECC2LHWH	2 piece	5
EECC2RHWH	2 piece	5



Compact 2 Internal bend

code	description	pack
EIBC2WH	2 piece	5



Compact 2 Internal bend assembly and cover only

code	description	pack
ELIBCD2WH	assemblies	1



Compact 2 External bend

code	description	pack
EXBC2WH	2 piece	5



Compact 2 Flat angle - upward

code	description	pack
EFAC2UWH		1



Compact 2 Flat angle - downward

code	description	pack
EFAC2DWH		1

Compact 2 flat tees

Compact 2 flat tees are handed to the left or to the right side. For the product you require, please order the following:

Left upward = EFTC2ULWH

Left downward = EFTC2DLWH

Right upward = EFTC2URWH

Right downward = EFTC2DRWH

For further advice please call the Technical Team on +44 (0)1424 856688.

Fittings

**Square mini trunking adapter**

code	size	pack
ESTA2WH	MMT2	5

**Square mini trunking adapter**

code	size	pack
ESTA4WH	MMT4	5

Allows the transfer of cables from Compact 2 to Marshall-Tufflex Mini Trunking

Components

**Dividing fillet**

code	pack
EDF1	8 x 3m

**Steel screening divider**

code	pack
ESF1	1 x 1.5m

Note: optional steel screening divider to assist in compliance with BS EN 50174-2

**Steel screening divider bonding strap**

code	pack
ESF2	5

**Bonding strap**

code	pack
ESBS1	5

**Main crossover bridge**

code	pack
EMCB1	5

Provides segregation of services crossing from one compartment to another

**Main cable retainer**

code	pack
EMCR1	10

The recommended cable retainer for all compartments which use the ETL1WH lid

Boxes and plates

***RCD/MCB housing**

code	pack
EAHC1MWH	1

*Up to 4 modules can be accommodated

Note: RCDs are not supplied by Marshall-Tufflex

**1 gang accessory box**

code	depth	pack
ESSB1WH	30mm	20

**2 gang accessory box**

code	depth	pack
ESSB2WH	30mm	10

**Accessory box spacer**

code	size	pack
ES1WH	14mm	4

For use between accessory boxes

**1 gang adjustable depth box**

code	depth	pack
EAB1WH	32 – 47mm	10

**2 gang adjustable depth box**

code	depth	pack
EAB2WH	32 – 47mm	5

Please see page 261 for more information on the range of adjustable boxes

**1 gang accessory plate**

code	pack
ESSP1WH	2

**2 gang accessory plate**

code	pack
ESSP2WH	2

Part M

For boxes that meet the requirements of Part M (DDA) please refer to page 54.