

PrimaVision for SDW-TG

HID-PV 50 /S SDW-TG 220-240V 50/60Hz



Robust, lightweight and one-piece HID electronic gear for SDW-TG lamps (mini White SON)Lightweight, one-piece electronic gear for 50 and 100 W SDW-TG lamps (mini White SON)

Product data

• General Characteristics

Rated Number of Lamps	1 piece
Rated Ballast-Lamp Power	50
Rated Lamptype	SDW-TG
Line Voltage	220-240 V
Line Frequency	50/60 Hz
Housing	/S
Suitable for Outdoor use?	No

• Operating Characteristics

Automatic restart	Yes
Constant wattage deviation	-3%/+3%
Inrush current Peak	24 (max) A
Inrush current Width	0.35 ms
Max ballast on MCB(16A type B)	24 x
Mains voltage safety (AC)	-18%/+10%
Mains voltage performance (AC)	-10%/+6%
Min. Mains voltage operational	180 (min) V
Operating frequency *	0.14 kHz
Overvoltage protection 320Vac	48 hr
PowerFactor 100% output power	0.95 -
Power losses gear	6 W
Ignition switch-off time	6 min
Ignition Voltage	3.3 (min), 4.0 (max) kV

Hum and Noise level Inaudible

• Wiring Characteristics

Connector type	Insert
Max. cable length	2 m
Device/Lamp Striplength	10.0-11.0 mm
Wcs Ballast contacts	0.50-2.50 mm ²

• Temperature Characteristics

Active temperature protection	Yes
T-case life	75 C
T-case maximum	85 (max) C
T-ambient	-20 (min), 60 (max) C
T-storage	-25 (min), 80 (max) C

• Product Dimensions

Length A1	150.0 mm
Fixing Hole Distance	133.6 mm
Length A2	
Width B1	90.0 mm
Fixing Hole Distance	70.0 mm
Width B2	
Height C1	37.0 mm
Fixing Hole Diameter D1	4.5 mm

• Approval & Application Chars

EMI 9 kHz ... 300MHz	CISPR 15 ed 7.2
Vibrations	IEC 68-2-6 Fc
Bumps	IEC 68-2-29 Eb
CE marking	Yes

PHILIPS

sense and simplicity

ENEC certificate	Yes
VDE certificate	No
VDE-EMV certificate	No
CB Certificate	Yes

Pieces per pack	1
Packing configuration	10
Packs per outerbox	10
Bar code on pack - EAN1	8711500881878
Bar code on outerbox - EAN3	8727900887532
Logistic code(s) - 12NC	913700656666
Net weight per piece	0.310 kg

• Product Data

Order code	887532 00
Full product code	872790088753200
Full product name	HID-PV 50 /S SDW-TG 220-240V 50/60Hz
Order product name	HID-PV 50 /S SDW-TG 220-240V 50/60Hz

Dimensional drawing

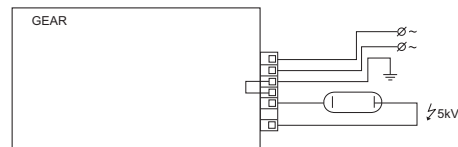
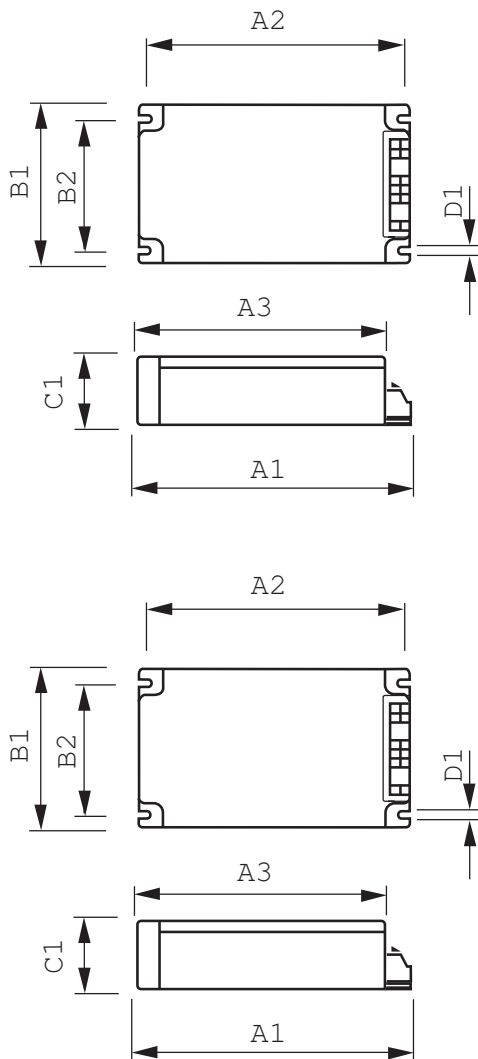

© 2012 Koninklijke Philips Electronics N.V.
All rights reserved.

Specifications are subject to change without notice. Trademarks are the property of Koninklijke Philips Electronics N.V. or their respective owners.

www.philips.com/lighting

2012, August 4
data subject to change