

D-Line Trunking Case Study



When 20,000 hotel rooms needed to hide cables for new heating controllers, D-Line Mini Trunking proved the perfect choice... Using D-Line saved a small fortune compared to the cost of channelling the walls, then needing to co-ordinate works to re-plaster and re-decorate.

Aside the noise and disruption, trying to recess the cabling would have put rooms out-of-service. However traditional trunking did not look suitable for a hotel chain with a reputation for comfort and style.

Cables from wall mounted heaters to wall mounted controllers were concealed in D-Line Mini Trunking which blended with the skirting, and, when necessary, up-and-around bedheads.

A cut-length rose up to the heater via a Clip-Over Equal Tee, while Clip-Over Internal Bends made internal corner connections quick and easy. The Flat Bend required was the Smooth-Fit version, as the secure internal tabs were favoured to eliminate future maintenance concerns, given that this part was most likely to be bumped by guests' baggage.

The ½ round shape of the length rising up to the wall-mounted controller was preferred also for its impact resistance, the lack of sharp edge a distinct benefit (compared to traditional sharp edge trunking).

The D-Line Cutting Tool was used throughout, saving time and leaving no PVC dust residue. The self-adhesive tape was used to attach the lengths to the walls, with a screw-fixing and plug then inserted 750mm from each end.

The result was 20,000 installations using 200km - all easy to fit, quick to install and blending with decor.

Further details on request.

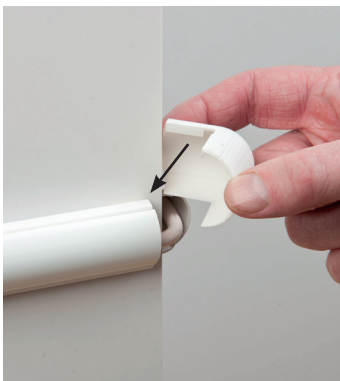

Unique Clip-Over Accessories

Saves Channelling Walls

Quick and Easy to Fit