

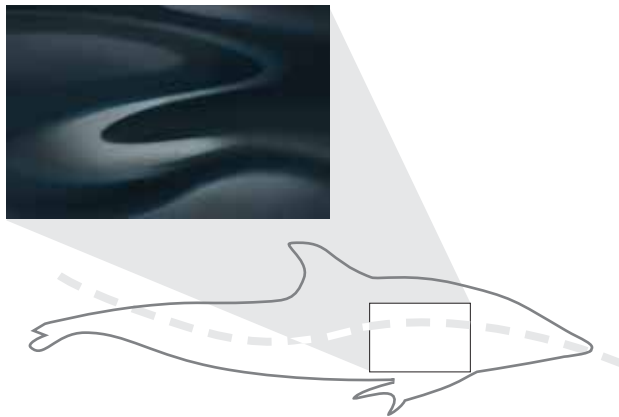

TAPS, SHOWERS, CISTERN FRAMES AND FLUSH VALVES

THE BLUE PATTERN



DUSKY DOLPHIN

They reside in the coastal waters of the Southern Hemisphere. The Dusky Dolphin is very social, and their pods can be more than 1,000 members. It is believed that the larger numbers come together for feeding and that there are plenty of subgroups within a larger pod. They are very acrobatic and can be seen leaping out of the water.



Dolphin Blue is the colourful name we've given to all our water-related washroom products and fittings, from intelligent infra-red taps and urinal flushes to elegantly recessed shower heads and cunningly concealed cistern frames.

Right across this extremely varied range, thoughtful design goes hand in hand with outstanding value for money. With Dolphin Blue, there's no need to splash out a fortune to achieve precisely the washroom you have in mind.

Touch-free taps eliminate cross-contamination; while adjustable flow rates deliver water and energy savings of up to 80% – easily achieving BREEAM targets. In terms of aesthetics, too, Dolphin Blue looks equally good – offering counter-mounted, panel-mounted and behind-mirror tap options. Plus a choice of satin stainless steel, satin chrome, and polished brass finishes, as well as the full range of RAL powder-coated colours.

As for long-term reliability, all Dolphin Blue products are made to perform day after day, year after year – with the reassurance of full factory warranty, and dedicated technical support.

One of our key features here is the matching soap dispensers and taps that we offer:

CASE STUDY **2**

COLLECTION **4**

PRODUCT CATEGORIES

PANEL MOUNTED TAPS	6	WASTE TRAPS	23
COUNTER MOUNTED TAPS	14	ACCESSORIES	24
BEHIND MIRROR TAPS	19	CISTERN FRAMES	26
SHOWER HEADS	22	FLUSH PLATES	29



CASE STUDY

THE SSE HYDRO GLASGOW, SCOTLAND

When leading London architects transformed Glasgow's skyline with a phenomenal modern landmark, they turned to Dolphin for their washroom needs...

The SSE Hydro is a purpose built entertainment venue which opened in Glasgow in September 2013.

WHAT DOLPHIN DELIVERED

Foster & Partners were looking for reliable, good quality taps to handle big crowds in a short concentration of time. We supplied them with WRAS approved Dolphin infra-red sensor taps which saved water and added a touch of style.

But that's not all these highly intelligent taps did. Their extremely low flow rate even reduced the building's carbon footprint and minimised environmental impact in line with BREEAM assessment criteria.

At Dolphin, we understand the importance of protecting our planet, which is why we invest in the potential of technology to keep our ecosystem going. Our WRAS approved taps are just one example of how a greener washroom doesn't have to cost you the world.

It plays host to national and international artists and bands as well as being a venue for major comedy stars and sporting events.

With a seating capacity of 12,000, The SSE Hydro augments the SECC Glasgow's existing event venue portfolio as an additional iconic architectural landmark on the banks of the River Clyde. The Foster + Partners designed building will play host to around 140 events each year, and will attract an audience of one million visitors each year.

The venue is ranked in the top five busiest indoor entertainment arenas in the world alongside such iconic venues as Madison Square Garden in New York and The O2 in London.

FOR FULL TECHNICAL DETAILS SEE DOLPHINSOLUTIONS.CO.UK



Architect: Foster & Partners

FEATURED PRODUCTS



DB100

LUXURY OFFICE COLLECTION



FEATURED PRODUCTS



WA100



DPI105



DB795



DP5103



DP3104



COLLECTION CURATED BY
JAMES WOODFORD

These prestigious fittings will transform any busy commercial washroom into an away-from-home bathroom experience. The stainless steel fittings have been designed and built to spec, not budget, and inspire confidence, exceed expectations in both form and function and remain beautiful for years.



DP7405



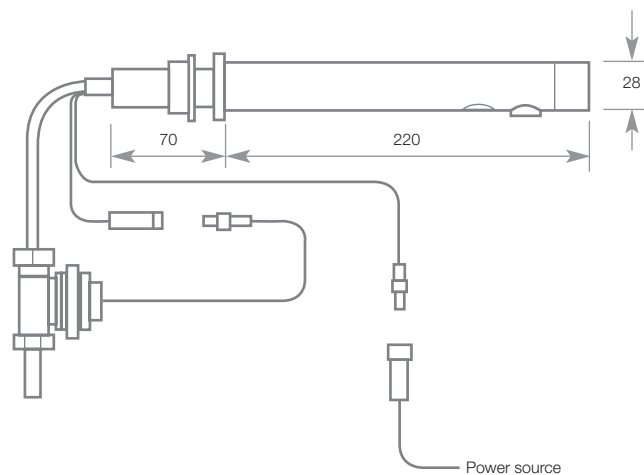

28 MM DIAMETER
220 MM PROJECTION

- > Touch Free Tap – for ultimate hygiene – prevents cross contamination
- > Quality polished or brushed chrome plated brass finishes available
- > Wall-mounted faucet. Combines a minimalistic design with vandal resistant features. Helps washrooms stay clean and saves water. Easy installation. Long lasting even in the harshest installation sites. Ideal for shopping malls, sport facilities and entertainment centres
- > WRAS Approved
- > Matching soap dispenser – [BC632F](#)

PRODUCT CODES

BATTERY POWERED

- > Brushed chrome [DBI400S](#)
- > Polished chrome [DBI400C](#)

TRANSFORMER POWERED

- > Brushed chrome [DBI425S](#)
- > Polished chrome [DBI425C](#)



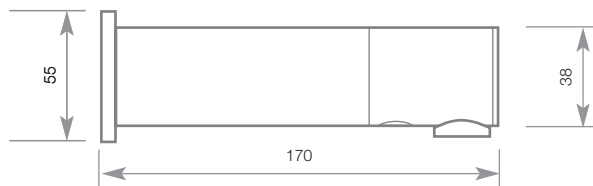

38 mm DIAMETER
170 mm PROJECTION

PRODUCT CODES

BATTERY POWERED

- > Brushed chrome **DB400S**
- > Polished chrome **DB400C**

TRANSFORMER POWERED

- > Brushed chrome **DB425S**
- > Polished chrome **DB425C**

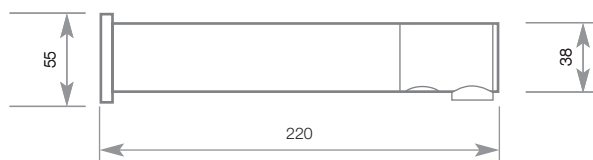

38 mm DIAMETER
220 mm PROJECTION

PRODUCT CODES

BATTERY POWERED

- > Brushed chrome **DBL400S**
- > Polished chrome **DBL400C**

TRANSFORMER POWERED

- > Brushed chrome **DBL425S**
- > Polished chrome **DBL425C**

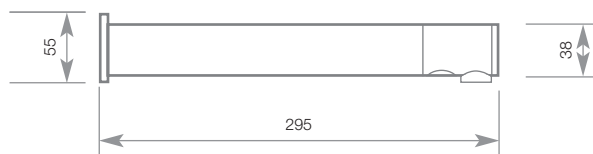

38 mm DIAMETER
295 mm PROJECTION

PRODUCT CODES

BATTERY POWERED

- > Brushed chrome **DBXL400S**
- > Polished chrome **DBXL400C**

TRANSFORMER POWERED

- > Brushed chrome **DBXL425S**
- > Polished chrome **DBXL425C**

- > Touch Free Tap – for ultimate hygiene – prevents cross contamination
- > Quality polished or brushed chrome plated brass finishes available
- > Wall-mounted faucet. Combines a minimalistic design with vandal resistant features. Helps washrooms stay clean and saves water. Easy installation. Long lasting even in the harshest installation sites. Ideal for shopping malls, sport facilities and entertainment centres
- > WRAS approved
- > Matching soap dispenser – **BC632F**

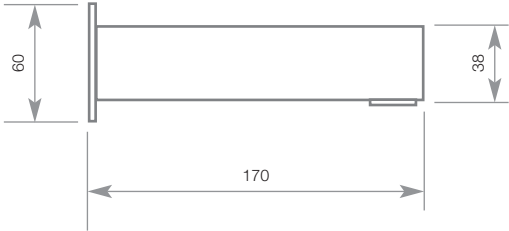

38 MM HEIGHT
38 MM WIDTH
170 MM PROJECTION

- > Touch Free Tap – for ultimate hygiene – prevents cross contamination
- > Quality polished or brushed chrome plated brass finishes available
- > Wall-mounted faucet. Combines a modern design with vandal resistant features. Helps washrooms stay clean and saves water. Easy installation. Long lasting even in the harshest installation sites. Ideal for shopping malls, sport facilities and entertainment centres
- > Available as a 220mm projection version – **DBLI500**
- > Matching soap dispenser – **BC635C**

PRODUCT CODES

BATTERY POWERED

- > Brushed chrome **DBI500C**
- > Polished chrome **DBI500S**

TRANSFORMER POWERED

- > Brushed chrome **DBI525S**
- > Polished chrome **DBI525C**

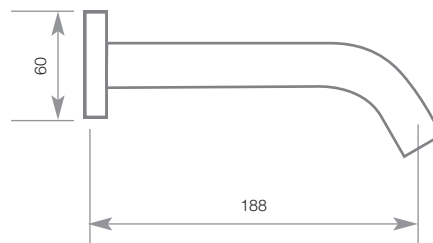

60 MM DIAMETER
188 MM PROJECTION

- › Quality chrome plated brass construction
- › Sensor window is at water outlet allowing easy and fast activation
- › Projection 188mm from wall to centre of spout
- › Distance from work top 300mm
- › Can be battery or transformer powered
- › WRAS Approved



DBI675 DOLPHIN BLUE PANEL MOUNTED MANUAL TAP

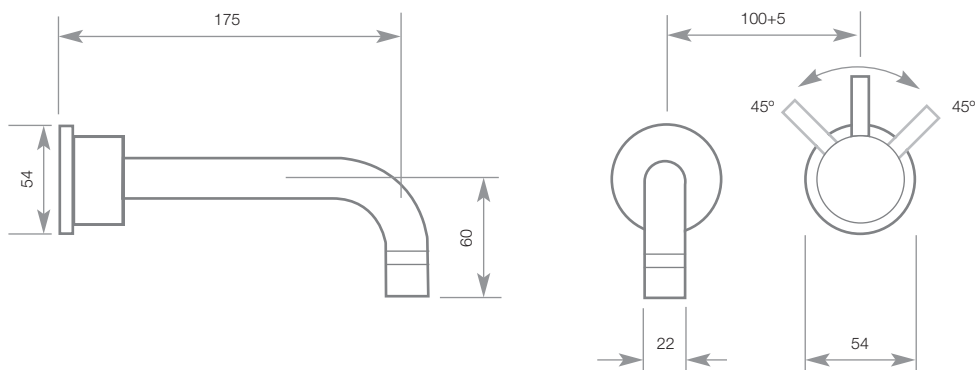

87 MM HEIGHT
22 MM DIAMETER
186 MM PROJECTION

- › NEW stylish wall/panel mounted monoblock mixer tap
- › Manufactured from high-quality, highly durable 304 stainless steel
- › Interchangeable Neoperl Aerator insert
- › Designed to be mounted on the wall behind an IPS panel
- › Requires a separate hot and cold supply; a balanced pressure is ideal for optimum performance – a **DB61** TMV3 valve can be fitted in conjunction with this tap
- › WRAS Approved



DBI00-STL / DBI25-STL DOLPHIN BLUE ELECTRONIC INFRARED TAP

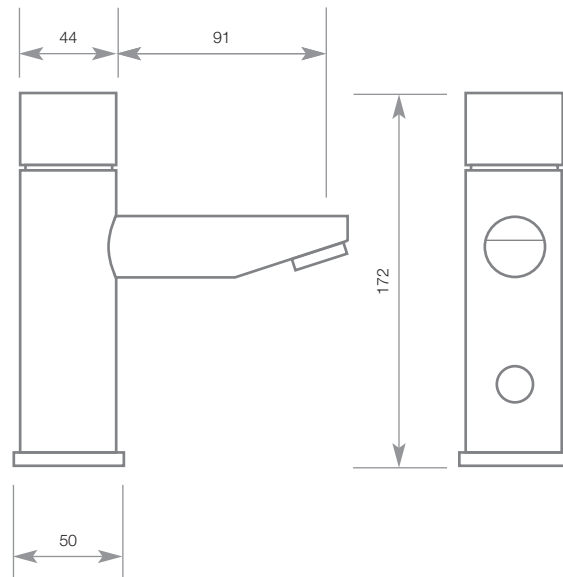

172 MM HEIGHT
44 MM DIAMETER
91 MM PROJECTION

- > Touch Free Tap – for ultimate hygiene – prevents cross contamination
- > Quality polished or brushed chrome plated brass finishes available
- > Deck-mounted faucet. Combining an elegant minimalist design with anti-vandal features. Easy installation. Long lasting even in the harshest installation sites. Helps washrooms stay clean and saves water. Ideal for stadiums, train and bus stations and highway rest stops
- > WRAS approved
- > Single water feed
- > Matching soap dispenser – [BC633F](#)

PRODUCT CODES

BATTERY POWERED

- > Polished chrome [DBI00C-STL](#)
- > Brushed chrome [DBI00S-STL](#)

TRANSFORMER POWERED

- > Polished chrome [DBI25C-STL](#)
- > Brushed chrome [DBI25S-STL](#)

DB200 / DB225 DOLPHIN BLUE COUNTER MOUNTED ELECTRONIC INFRA RED TAP
DBL200 / DBL225 DOLPHIN BLUE COUNTER MOUNTED ELECTRONIC INFRA RED TAP

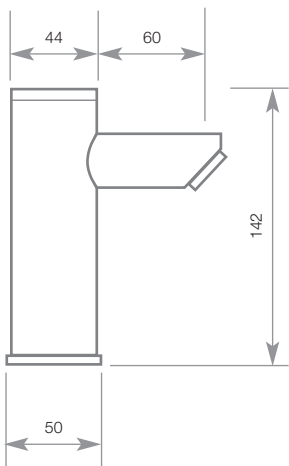

142 MM HEIGHT
44 MM DIAMETER
60 MM PROJECTION

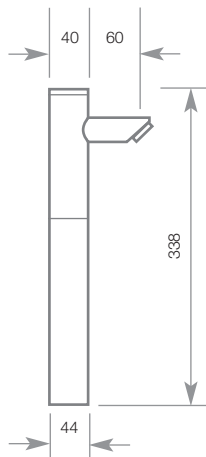

338 MM HEIGHT
40 MM DIAMETER
60 MM PROJECTION

PRODUCT CODES

BATTERY POWERED

- > Polished chrome DB200C
- > Brushed chrome DB200S

TRANSFORMER POWERED

- > Polished chrome DB225C
- > Brushed chrome DB225S

PRODUCT CODES

BATTERY POWERED

- > Polished chrome DBL200C
- > Brushed chrome DBL200S

TRANSFORMER POWERED

- > Polished chrome DBL225C
- > Brushed chrome DBL225S

- > WRAS approved touch free tap – for ultimate hygiene – prevents cross contamination
- > Quality polished or brushed chrome plated brass finishes available
- > Deck-mounted faucet. Combining an elegant minimalist design with anti-vandal features. Easy installation. Long lasting even in the harshest installation sites. Helps washrooms stay clean and saves water. Ideal for stadiums, train and bus stations and highway rest stops
- > Single water feed
- > Matching soap dispenser – BC633F

DB150 / DB175 DOLPHIN BLUE ELECTRONIC INFRARED TAP WITH TEMPERATURE ADJUSTMENT LEVER
DB250 / DB275 DOLPHIN BLUE ELECTRONIC INFRARED TAP WITH TEMPERATURE ADJUSTMENT LEVER

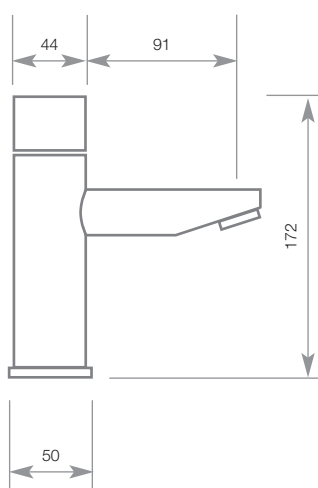

172 MM HEIGHT
44 MM DIAMETER
91 MM PROJECTION

PRODUCT CODES

BATTERY POWERED

- > Brushed chrome **DB150S**
- > Polished chrome **DB150C**

TRANSFORMER POWERED

- > Brushed chrome **DB175S**
- > Polished chrome **DB175C**

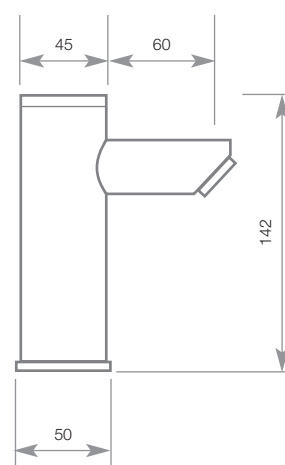

142 MM HEIGHT
45 MM DIAMETER
60 MM PROJECTION

PRODUCT CODES

BATTERY POWERED

- > Polished chrome **DB250C**
- > Brushed chrome **DB250S**

TRANSFORMER POWERED

- > Polished chrome **DB275C**
- > Brushed chrome **DB275S**

- > WRAS approved touch free tap – for ultimate hygiene – prevents cross contamination
- > Quality polished or brushed chrome plated brass finishes available
- > Deck-mounted faucet. Combining an elegant minimalist design with anti-vandal features. Easy installation. Long lasting even in the harshest installation sites. Helps washrooms stay clean and saves water. Ideal for stadiums, train and bus stations and highway rest stops
- > Hot and cold water feed needed
- > Matching soap dispenser – **BC633F**

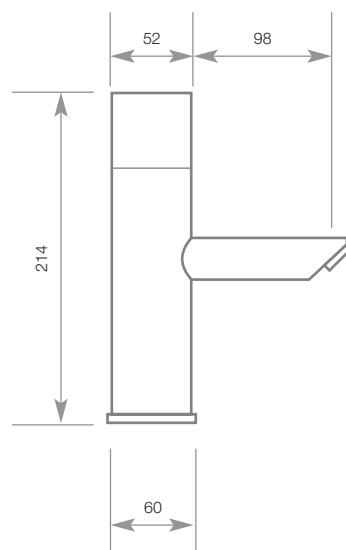

214 MM HEIGHT
52 MM DIAMETER
98 MM PROJECTION

- > Includes a built in TMV for water temperature control
- > Deck-mounted faucet. Combining an elegant minimalist design with anti-vandal features. Easy installation. Long lasting even in the harshest installation sites. Helps washrooms stay clean and saves water. Prevents cross contamination. Ideal for hospitals, laboratories, dental clinics and commercial kitchens
- > WRAS approved

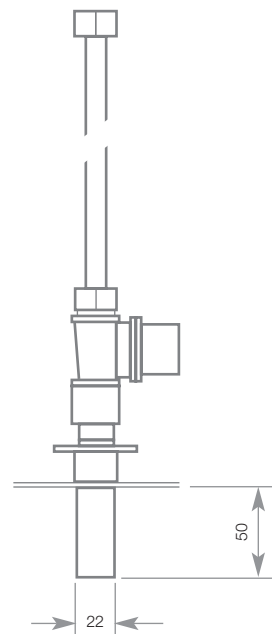

50 MM HEIGHT
22 MM DIAMETER

- > Behind MirrorTap which is easy to install and plumb
- > Combining an elegant minimalist design with anti-vandal features. Easy installation. Long lasting even in the harshest installation sites. Helps designers save space in the washroom and save water. Ideal for shopping malls, sport facilities, entertainment centers, hotel, airports and transportation hubs.

DB1600 DOLPHIN MONOBLOC MIXER TAP

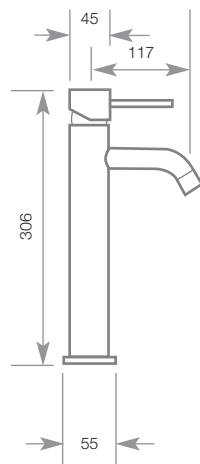

306 MM HEIGHT
45 MM DIAMETER
117 MM PROJECTION

- > New stylish counter mounted monobloc mixer taps
- > Manufactured from high-quality, highly durable 304 stainless steel
- > Interchangeable Neoperl Aerator insert
- > Requires a separate hot and cold supply; a balanced pressure is ideal for optimum performance – a **DB61** TMV3 valve can be fitted in conjunction with this tap.
- > WRAS approved

DB1650 DOLPHIN MONOBLOC MIXER TAP

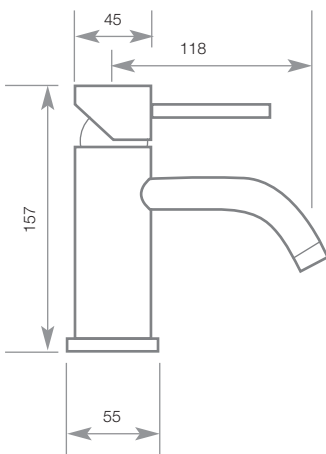

157 MM HEIGHT
45 MM DIAMETER
118 MM PROJECTION

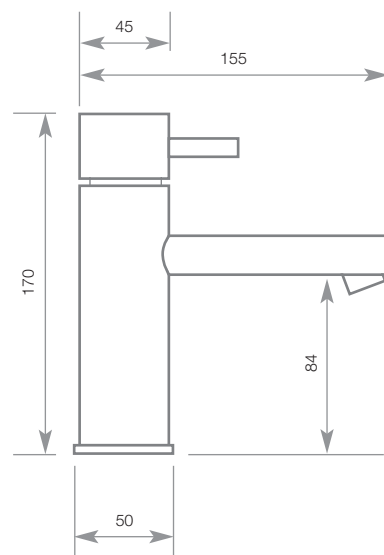

170 mm HEIGHT
45 mm DIAMETER
155 mm PROJECTION

- > Prestige stainless steel tap
- > Manufactured from high-quality, highly durable 304 stainless steel
- > Interchangeable Neoperl Aerator insert
- > Requires a separate hot and cold supply; a balanced pressure is ideal for optimum performance – a **DB61** TMV3 valve can be fitted in conjunction with this tap

DB1031 DOLPHIN SHOWER HEAD, WALL MOUNTED – REAR INLET



62 MM HEIGHT
77 MM WIDTH

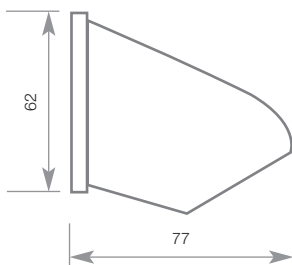

- > High quality chrome plated solid brass construction.
- > Vandal resistant
- > Rear inlet (**BC1031**) bottom inlet (**BC1032**)
- > Anti-ligature
- > Ideal for public shower facilities, including: prisons, sport facilities, swimming pools, hospitals and schools
- > Easy clean nozzles – lime deposits can be easily rubbed off due to soft silicone nozzles

DB1032 DOLPHIN SHOWER HEAD, WALL MOUNTED – BOTTOM INLET



62 MM HEIGHT
98 MM WIDTH

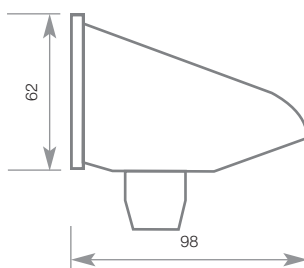

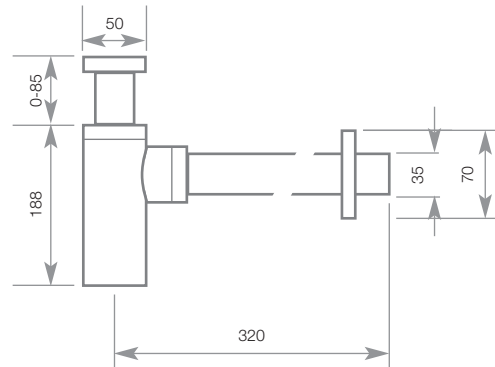
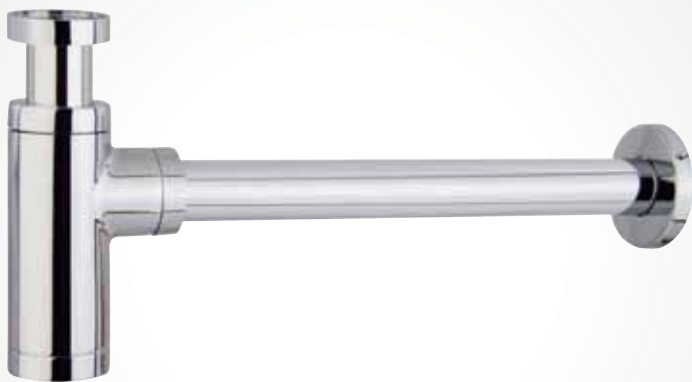

148-218 mm	HEIGHT
320 mm	PROJECTION
60 mm	BOTTLE DIAMETER

- > 32mm / G1 1/4" high quality chrome-plated brass bottle trap
- > 75mm deep trap
- > Suitable for sinks and basins.
- > Telescopic, with a 70mm wall seal and minimalist 75mm trap
- > Waste outlet length: 320mm from centre of trap
- > Bottle Diameter: 60mm

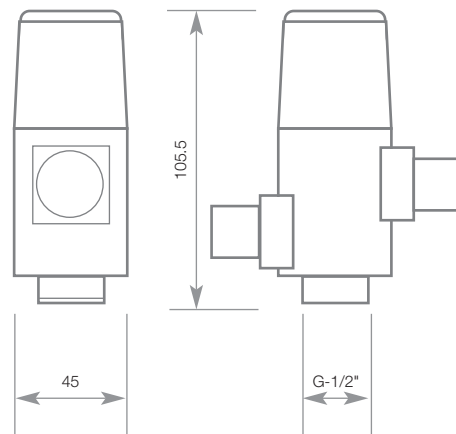

105.5 MM HEIGHT
45 MM DIAMETER

- › Thermostatic mixing valve allowing easy adjustment of hot and cold water
- › Prevents scalding
- › Manually set the water temperature at any given time
- › WRAS Approved

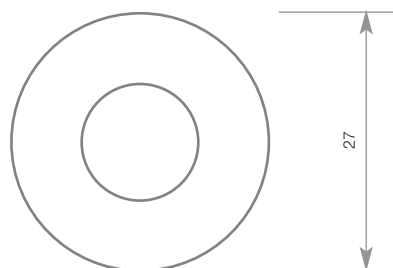

27 MM DIAMETER

- › Touch free proximity sensors – eliminates cross contamination. Senses when user is present and flushes urinal when user walks away
- › Quality polished chrome plated brass finish
- › Direct flush does not incorporate or work with cistern, this saves the bacteria growth associated with stored water
- › Needs a 15mm feed
- › 2 years manufacturer's warranty
- › Pressure: 0.5 - 8.0 bar (7-116 PSI)
- › Powered by 9v battery



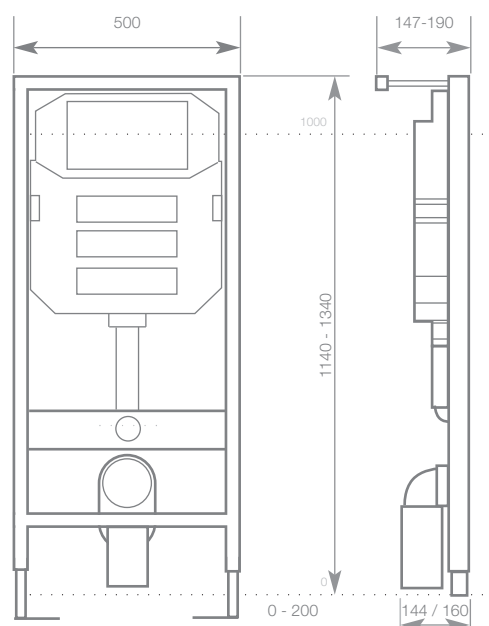

1140-1430 mm HEIGHT
500 mm WIDTH
147-190 mm PROJECTION

- › Universal frame 1140mm
- › Depth of cistern 120mm
- › Galvanised leg supports, adjustable from 0 - 200mm
- › Concealed cistern fully insulated against condensation
- › Adjustable dual-flush valve 6/3L, 4.5/3L or 4/2L
- › Water supply connection R 1/2"
- › Protection plug for flush pipes
- › Protection cover for service opening
- › Threaded rods M12 for ceramics fastening
- › WC connection set, dia. 90mm
- › WC outlet bend, HDPE or PVC, diameter 90mm or 110mm

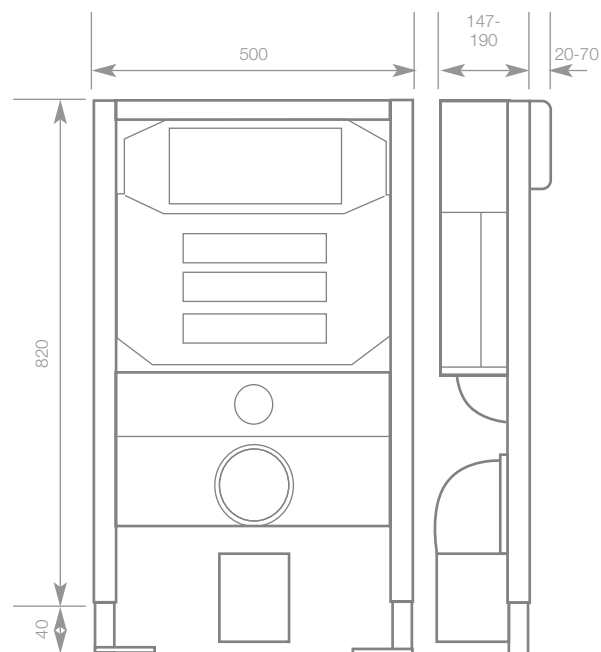

820-1020 mm HEIGHT
 500 mm WIDTH
 147-190 mm PROJECTION

- > Front or top operating, low level frame
- > Universal frame 820mm
- > Depth of cistern 130mm
- > Galvanised leg supports, adjustable from 0 - 200mm
- > Concealed cistern fully insulated against condensation
- > Adjustable dual-flush valve 6/3L, 4.5/3L
- > Water supply connection R 1/2"
- > WRAS approved

DB586
DB587

DOLPHIN CHROME ABS FLUSH PLATE
DOLPHIN CHROME ABS FLUSH PLATE

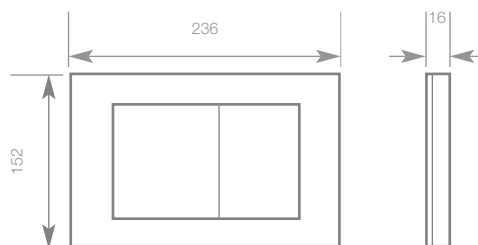

152 MM HEIGHT
236 MM WIDTH
16 MM PROJECTION

- > Very high quality mechanical ABS push plate
- > Chrome plated ABS **DB586**
- > Quality 304 stainless steel **DB587**

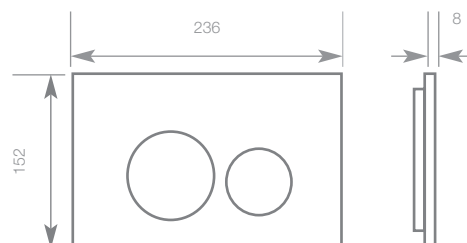

152 MM HEIGHT
236 MM WIDTH
8 MM PROJECTION

- > Mechanical push plate
- > Available in polished or satin stainless steel
- > Polished **DB582C**
- > Satin **DB582S**

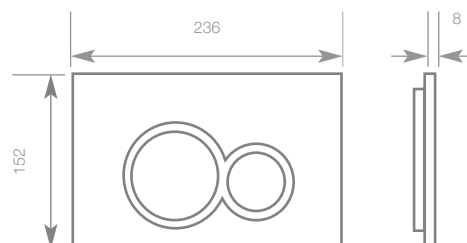
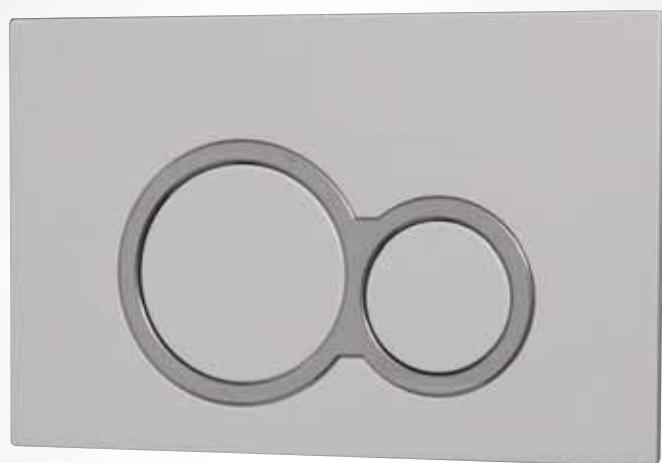

236 MM HEIGHT
152 MM DIAMETER
8 MM PROJECTION

- > Mechanical push plate
- > Available in white, chrome, black and silver
- > Matt white **DB583W**
- > Matt silver **DB583S**
- > Chrome **DB583C**
- > Matt black **DB583B**

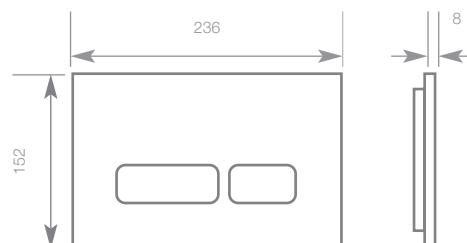
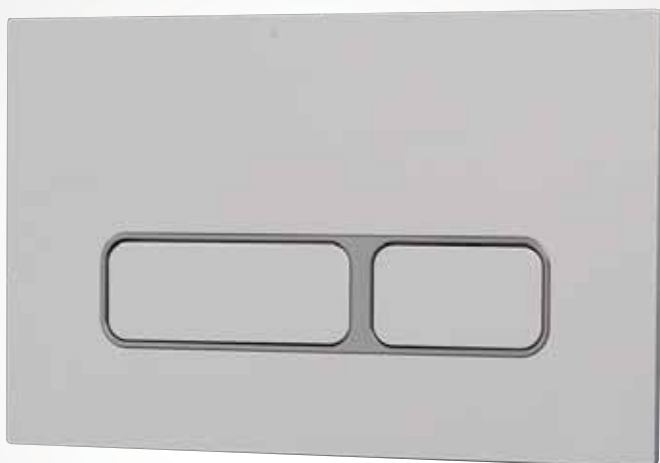

236 MM HEIGHT
152 MM DIAMETER
12 MM PROJECTION

- > Mechanical push plate
- > Available in white, chrome, black and silver
- > Matt white **DB584W**
- > Matt silver **DB584S**
- > Chrome **DB584C**
- > Matt black **DB584B**

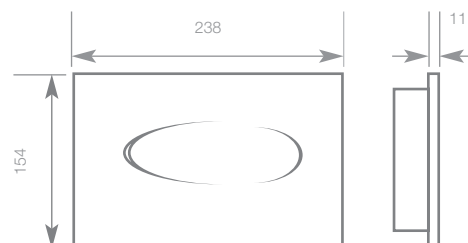

154 MM	HEIGHT
238 MM	DIAMETER
11 MM	PROJECTION

- › Black glass with two light fields to show a full and half flush
- › Touchless operation – simply wave in front of plate
- › Flushes automatically if user moves away without flushing
- › Used for high quality washrooms
- › A 220v power connection is needed to connect to the 9V transformer
- › Transformer included in package

Our Dolphin Blue texture was inspired by the Dusky Dolphin, a small but handsome species found in coastal waters throughout the southern hemisphere.

Dolphi Solutions Ltd
Southpoint, Compass Park,
Junction Road
Bodiam, TN32 5BS,
United Kingdom
T +44 (0)1424 202 224
info@dolphinsolutions.co.uk
dolphinsolutions.co.uk

© Dolphin Solutions Ltd