



# Cistern Frames and Flush Plates

Second Edition







*The Dolphin concealed cistern and flush plate range offers you a high quality solution to every modern washroom challenge*

## Contents

DB 580 Dolphin Concealed Cistern	4
DB 581 Dolphin Recessed Cistern	6
DB 582 Dolphin Stainless Steel Flush Plate	8
DB 583 Dolphin Stainless Steel Flush Plate	10
DB 584 Dolphin Stainless Steel Flush Plate	12
DB 585 Dolphin Glass Flush Plate	14



# Concealed Cistern Frames

## DB 580 Dolphin Concealed Cistern Frames

- Universal frame 1140mm
- Depth of cistern 120mm
- Galvanised leg supports, adjustable from 0 - 200mm
- Concealed cistern fully insulated against condensation
- Adjustable dual-flush valve 6/3L, 4.5/3L or 4/2L
- Water supply connection R 1/2"
- Protection plug for flush pipes
- Protection cover for service opening
- Threaded rods M12 for ceramics fastening
- WC connection set, dia. 90mm
- WC outlet bend, HDPE or PVC, diameter 90mm or 110mm

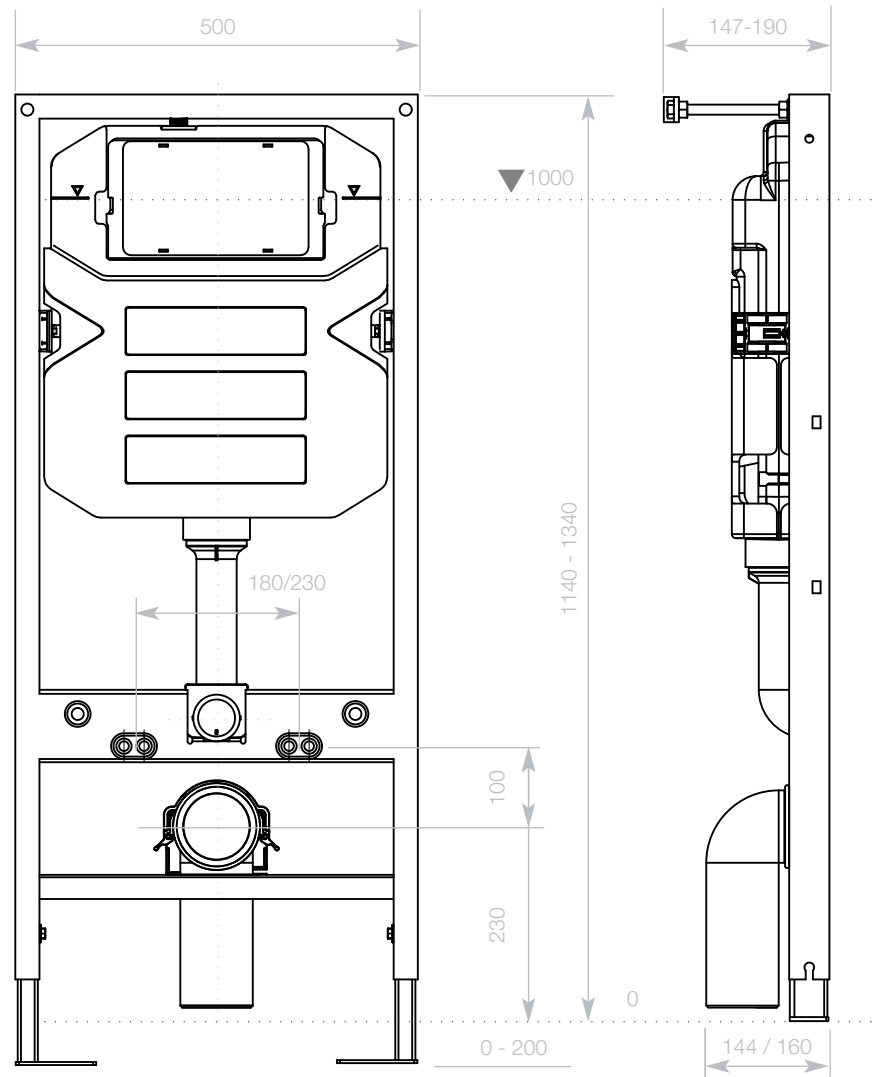

washrooms worth experiencing

technical helpline: 01424 20 22 24  
e: [info@dolphindispensers.co.uk](mailto:info@dolphindispensers.co.uk)



Front plate removed from the front of the unit

Flush valve replaced from the front of the unit

Half or full flush adjustable to 4/2 litres



# Concealed Cistern Frames

## DB 581 Dolphin Recessed Cistern Frames

- Front or top operating, low level frame
- Universal frame 820mm
- Depth of cistern 130mm
- Galvanised leg supports, adjustable from 0 - 200mm
- Concealed cistern fully insulated against condensation
- Adjustable dual-flush valve 6/3L, 4.5/3L
- Water supply connection R 1/2"
- Protection plug for flush pipes
- Protection cover for service opening
- Threaded rods M for ceramics fastening
- WC connection set, dia. mm
- WC outlet bend, HDPE or PVC, diameter 90mm or 110mm

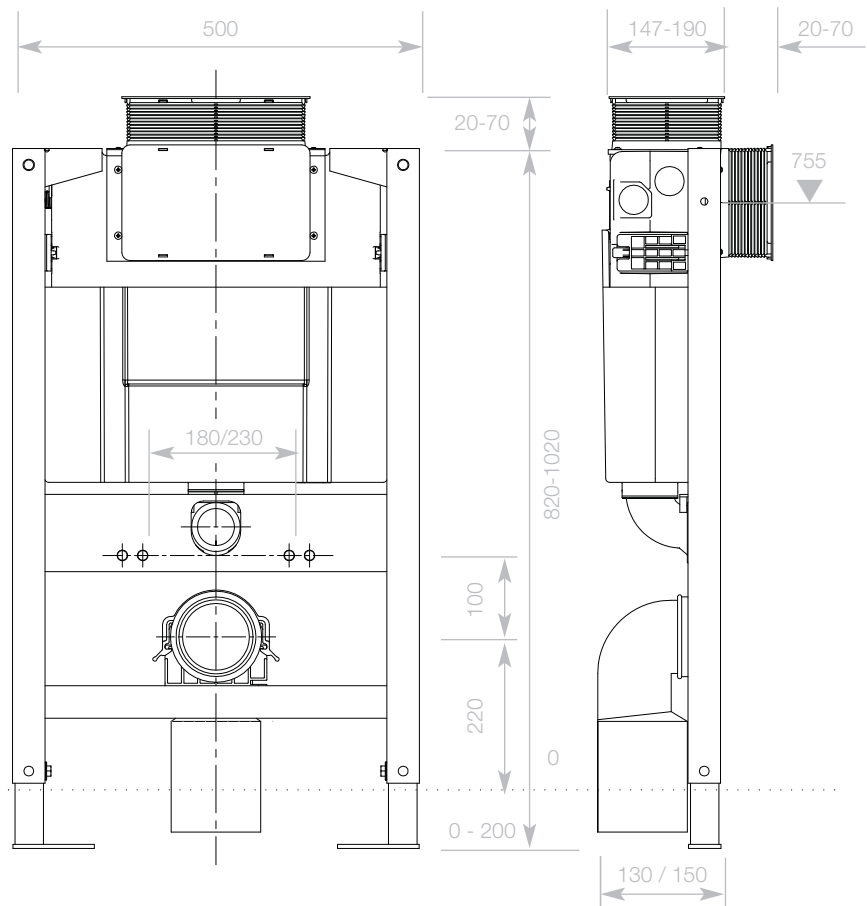

washrooms worth experiencing



Choice of Dolphin  
ABS or stainless  
steel flush plates  
can be used with  
the same frame

Easy to remove  
flush plates to  
enable servicing  
to be carried out  
from the front

Adjustable  
flush from 2-6  
litres

Slimline  
cistern to fit in  
any cavity  
wall

Robust frame  
tested to  
400kg

Cistern fully  
insulated to  
protect  
against  
condensation

Universal  
frame fits  
most toilet  
pans

Galvanised leg  
supports  
adjustable  
from 0-20cm



# Dual Flush Stainless Steel Plates

## DB 582 Dolphin Stainless Steel Flush Plate

- Mechanical push plate
- Used with concealed cistern DB 580/DB 581
- Available in polished or satin stainless steel



DB582C – Polished



DB582S – Satin

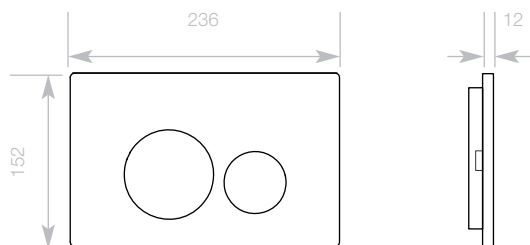

washrooms worth experiencing

technical helpline: 01424 20 22 24  
e: [info@dolphindispensers.co.uk](mailto:info@dolphindispensers.co.uk)





DB582S – Satin



# Dual Flush Circle Plates

## DB 583 Dolphin Circle Push Plate

- Mechanical push plate
- Used with concealed cistern DB 580/DB 581
- Available in white, chrome, black and silver



DB 583W – Matt White



DB 583S – Matt Silver



DB 583C – Chrome



DB 583B – Matt Black

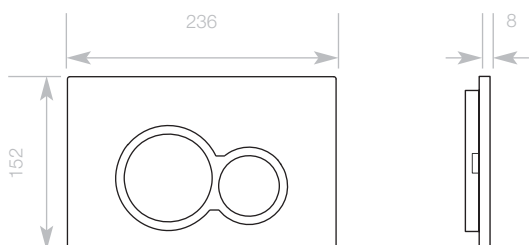

washrooms worth experiencing

technical helpline: 01424 20 22 24  
e: [info@dolphindispensers.co.uk](mailto:info@dolphindispensers.co.uk)

**10** Dolphin



DB583C – Chrome



# Dual Flush Push Plates

## DB 584 Dolphin Square Flush Plate

- Mechanical push plate
- Used with concealed cistern DB 580/DB 581
- Available in white, chrome, black and silver



DB 584W – Matt White



DB 584S – Matt Silver



DB 584C – Chrome



DB 584B – Matt Black

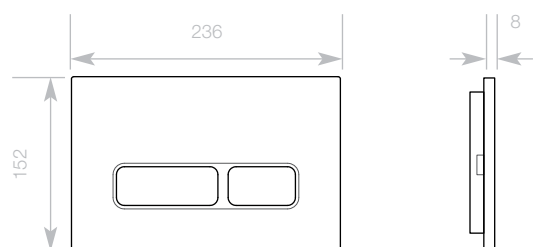

washrooms worth experiencing

technical helpline: 01424 20 22 24  
e: [info@dolphindispensers.co.uk](mailto:info@dolphindispensers.co.uk)





DB584C – Chrome



# Dual Flush Sensor Plates

## **DB 585 Dolphin Glass Flush Plate**

- Black glass with two light fields to show a full and half flush.
- Touchless operation – simply wave in front of plate.
- Flushes automatically if user moves away without flushing.
- Can be used with the DB580 or DB581 Concealed Frames
- Used for high quality washrooms
- A 220v power connection is needed to connect to the 9V transformer.
- Transformer included in package



washrooms worth experiencing

technical helpline: 01424 20 22 24  
e: [info@dolphindispensers.co.uk](mailto:info@dolphindispensers.co.uk)





DB585 Sensor Plate







washrooms worth experiencing

Bell-Chem Products Company  
Southpoint, Compass Park, Bodiam  
Robertsbridge TN32 5BS

Tel: 01424 202224  
Fax: 01424 205200  
[www: dolphindispensers.co.uk](http://www.dolphindispensers.co.uk)  
[info@dolphindispensers.co.uk](mailto:info@dolphindispensers.co.uk)

