



## TIMING RELAY

Part no.

DILET11-M-W

Article no.

048891



Powering Business Worldwide™

On-delayed

### Delivery programme

Product range			DILET timing relays
Basic function			Timer relays
Function			On-delayed
Number of changeover contacts			1
Time range			0.05 s - 60 h
Time range			u0.15 - 3 min 0.5 - 10 min 3 - 60 min 0.15 - 3 h 0.5 - 10 h 3 - 60 h
Rated operational current			
AC-11			
230 V	$I_e$	A	3
400 V	$I_e$	A	3
AC-15			
220 V 230 V 240 V	$I_e$	A	3
Voltage range	$U_{LN}$	V	400 V AC, 50/60 Hz
Width		mm	45
Conventional thermal current	$I_{th}$	A	6
Terminal marking according to EN 50042			

### Approvals

Product Standards  
UL File No.  
UL CCN  
CSA File No.  
CSA Class No.  
NA Certification  
Degree of Protection

IEC/EN 61812-1; IEC/EN 60947-5-1; UL 508; CSA-22.2 No. 14-05; CE marking  
E29184  
NKCR, NKCR7  
12528  
3211-03  
UL listed, CSA certified  
IEC: IP20, UL/CSA Type: -

### General

Standards			Standard IEC/EN 61812 VDE 0435
Lifespan, mechanical			
AC operated	Operations	$x 10^6$	30
DC operated	Operations	$x 10^6$	30
Climatic proofing			Damp heat, constant to IEC 60068-2-78 Damp heat, cyclic to IEC 60068-2-30
Ambient temperature		°C	
Open		°C	- 20 - 60
Enclosed		°C	- 20 - 45
Mounting position			As required
Mechanical shock resistance (IEC/EN 60068-2-27)			
Half-sinusoidal shock, 20 ms		g	
Make contact		g	4
Degree of protection			

Terminals			IP20
Weight		kg	0.09
Terminal capacities		mm <sup>2</sup>	
Solid		mm <sup>2</sup>	1 x (0.75 - 2.5) 2 x (0.75 - 2.5)
Flexible with ferrule		mm <sup>2</sup>	1 x (0.75 - 1.5) 2 x (0.75 - 1.5)
Solid or stranded		AWG	1 x (18 - 14)

## Contacts

Rated impulse withstand voltage	$U_{imp}$	V AC	6000
Overvoltage category/pollution degree			III/2
Rated insulation voltage	$U_i$	V AC	600
Rated operational voltage	$U_e$	V AC	440
Safe isolation to VDE 0106 Part 101 and Part 101/A1			
between coil and auxiliary contacts		V AC	250
between the auxiliary contacts		V AC	250
Making capacity			
AC-14 $\cos \varphi = 0.3$ 400 V		A	48
AC-15 $\cos \varphi = 0.3$ 220 V		A	50
DC-11 L/R - 40 ms		x $I_e$	1.1
Breaking capacity			
AC-14 $\cos \varphi = 0.3$ 440 V		A	3
AC-15 $\cos \varphi = 0.3$ 220 V		A	3
DC-11 L/R - 40 ms		x $I_e$	1.1
Rated operational current	$I_e$	A	
AC--14			
440 V	$I_e$	A	3
AC-15			
220 V 230 V 240 V	$I_e$	A	3
DC-11			
Note			Making and breaking conditions to DC13, time constant as stated
L/R max. 15 ms		A	
24 V	$I_e$	A	1.5
L/R max. 50 ms		A	1.2
Conv. thermal current	$I_{th}$	A	6
Short-circuit rating without welding			
Note			When supplied directly from mains or transformer > 1000 VA
Max. fuse, make contacts		A gG/ gL	6
Max. fuse, break contacts		A gG/ gL	6

## Magnet systems

Rated operational voltage	$U_e$	V	
AC			400
Voltage tolerance		x $U_c$	
Pick-up voltage		x $U_s$	
Min. pick-up voltage, AC operated		x $U_c$	0.85
Pick-up voltage AC operated, max.		x $U_c$	1.1
Power consumption			
Pick-up AC		VA	0.5
Sealing AC		VA	0.5

Duty factor		% DF	100
Maximum operating frequency		Ops/ h	4000
Minimum command time			
AC		ms	50
Repetition accuracy (deviation)		%	$\pm 0.5$
Recovery time (after 100% time delay)		ms	70

### Technical data ETIM 4.0

Number of outputs, delayed, N/O			0
Remote access possible			No
Number of outputs, non-delayed, N/O			0
Function off-delayed			No
Outputs, reversible delayed/non-delayed			YES
Type of electric connection			Screw connection
Number of outputs, non-delayed, N/C			0
Rated control voltage Us at DC		V	0
Clock function, starting with pulse, variable			No
Voltage type for actuation			AC
Function flashing, starting with pulse, fixed time			No
Function pulse shaping			No
Rated control voltage Us at AC 50HZ		V	400
Time range		s	216000
Number of outputs, non-delayed, change-over contact			1
With semi-conductor output			No
Suitable only for remote control			No
Function flashing starting with pause, fixed time			No
Plug-in type on auxiliary contact block			No
Width		mm	45
With plug-in socket			No
Function fleeting contact on energization			No
Function star/delta			No
Rated control voltage Us at AC 60HZ		V	400
Function fleeting contact on de-energization			No
Function on-delayed			YES
Height		mm	58
Depth		mm	52
Function cyclic starting with pause, variable			No
Number of outputs, delayed, N/C			0
Number of outputs, delayed, changeover contact			1

### Characteristics

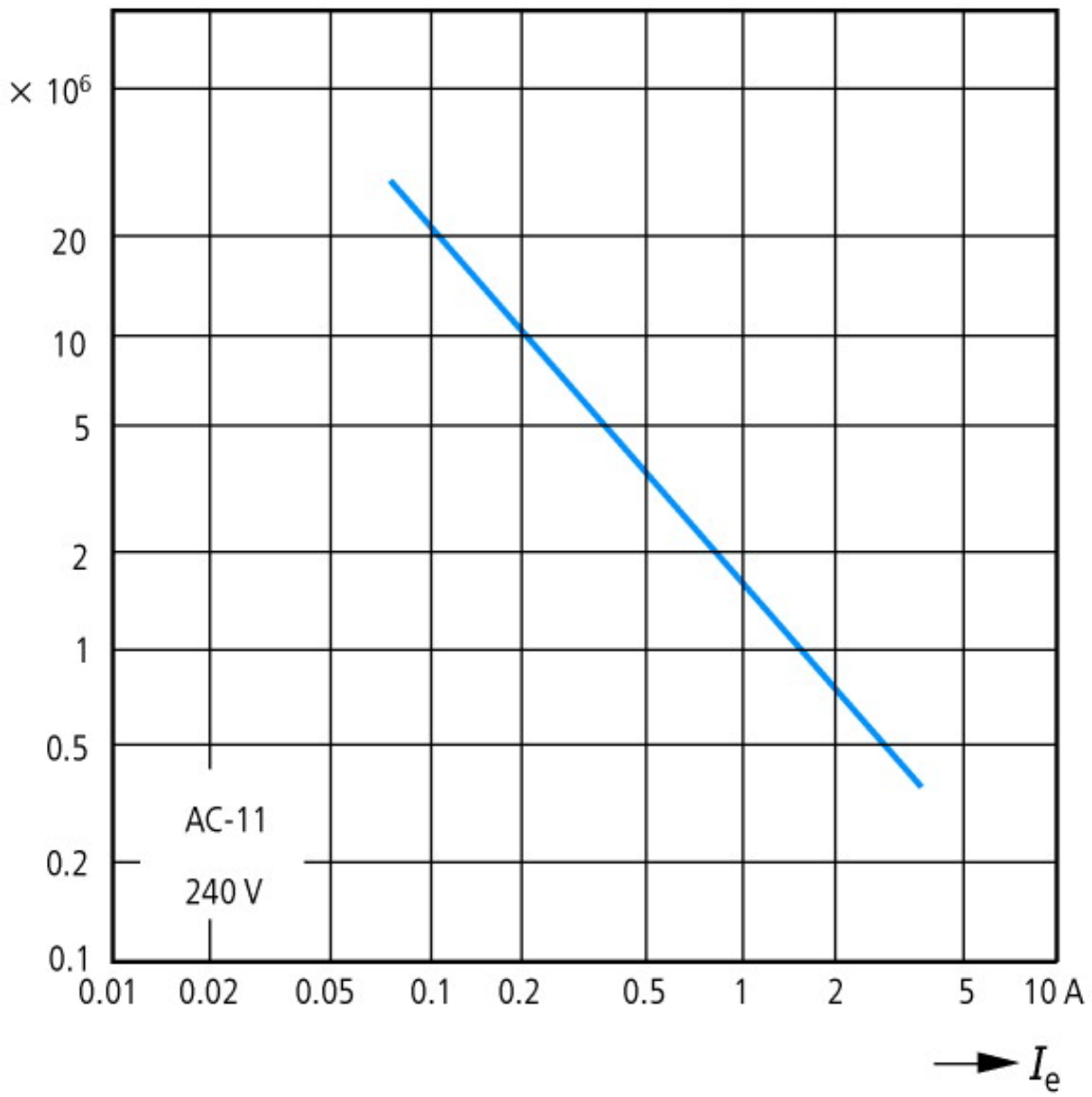

Component lifespan (operations)  
 $I_e$  = Rated operational current

### Dimensions

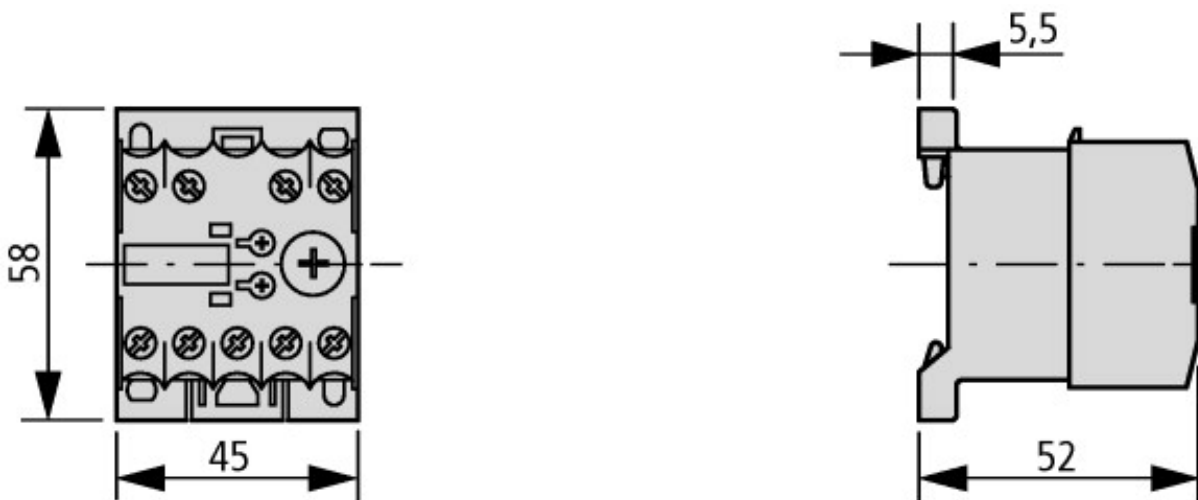

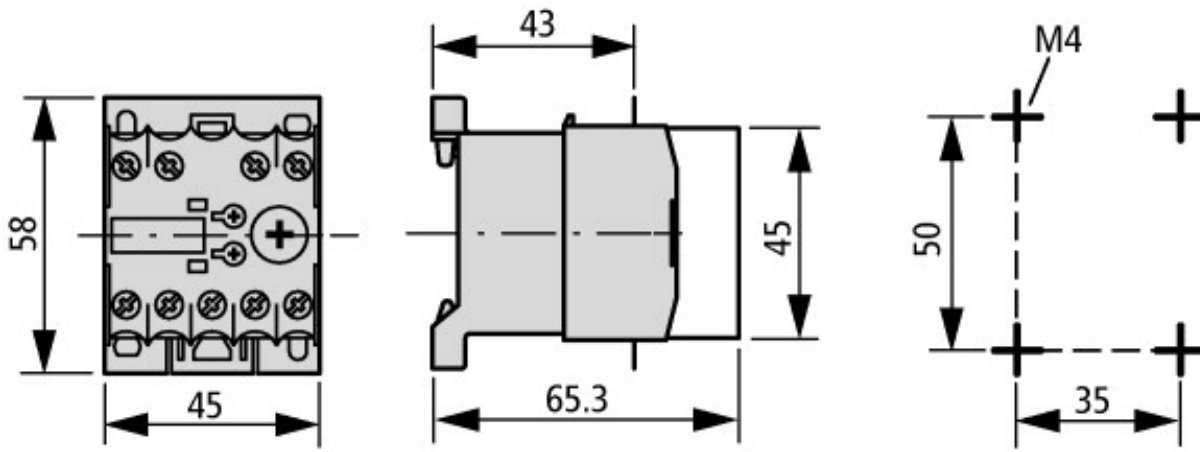

Electronic timing relay with sealable shroud  
DILET... + HDILE

**Additional product information (links)**

**IL04910003Z (AWA2527-1587) Solid-state timing relay**

IL04910003Z (AWA2527-1587) Solid-state timing relay

[ftp://ftp.moeller.net/DOCUMENTATION/AWA\\_INSTRUCTIONS/IL04910003Z2010\\_10.pdf](ftp://ftp.moeller.net/DOCUMENTATION/AWA_INSTRUCTIONS/IL04910003Z2010_10.pdf)