



## TIMING RELAY

Part no.

DILET11-M-A

Article no.

048886



Powering Business Worldwide™

On-delayed

### Delivery programme

Product range				DILET timing relays
Basic function				Timer relays
Function				On-delayed
Number of changeover contacts				1
Time range				0.05 s - 60 h
Time range				0.15 - 3 s 0.5 - 10 s 3 - 60 s u0.15 - 3 min 0.5 - 10 min 3 - 60 min 0.15 - 3 h 0.5 - 10 h 3 - 60 h
Rated operational current				
AC-11				
230 V	$I_e$	A	3	
400 V	$I_e$	A	3	
AC-15				
220 V 230 V 240 V	$I_e$	A	3	
Voltage range	$U_{LN}$	V		24 - 240 V AC, 50/60 Hz 24 - 240 V DC
Width		mm	45	
Conventional thermal current	$I_{th}$	A	6	
Terminal marking according to EN 50042				

### Approvals

Product Standards  
UL File No.  
UL CCN  
CSA File No.  
CSA Class No.  
NA Certification  
Degree of Protection

IEC/EN 61812-1; IEC/EN 60947-5-1; UL 508; CSA-22.2 No. 14-05; CE marking  
E29184  
NKCR, NKCR7  
12528  
3211-03  
UL listed, CSA certified  
IEC: IP20, UL/CSA Type: -

### General

Standards				Standard IEC/EN 61812 VDE 0435
Lifespan, mechanical				
AC operated	Operations	$x 10^6$	30	
DC operated	Operations	$x 10^6$	30	
Climatic proofing				Damp heat, constant to IEC 60068-2-78 Damp heat, cyclic to IEC 60068-2-30
Ambient temperature		°C		
Open		°C	- 20 - 60	
Enclosed		°C	- 20 - 45	
Mounting position				As required
Mechanical shock resistance (IEC/EN 60068-2-27)				
Half-sinusoidal shock, 20 ms		g		

Make contact		g	4
Degree of protection			
Terminals			IP20
Weight		kg	0.09
Terminal capacities		mm <sup>2</sup>	
Solid		mm <sup>2</sup>	1 x (0.75 - 2.5) 2 x (0.75 - 2.5)
Flexible with ferrule		mm <sup>2</sup>	1 x (0.75 - 1.5) 2 x (0.75 - 1.5)
Solid or stranded		AWG	1 x (18 - 14)

## Contacts

Rated impulse withstand voltage	$U_{imp}$	V AC	6000
Overvoltage category/pollution degree			III/2
Rated insulation voltage	$U_i$	V AC	600
Rated operational voltage	$U_e$	V AC	440
Safe isolation to VDE 0106 Part 101 and Part 101/A1			
between coil and auxiliary contacts		V AC	250
between the auxiliary contacts		V AC	250
Making capacity			
AC-14 $\cos \varphi = 0.3$ 400 V		A	48
AC-15 $\cos \varphi = 0.3$ 220 V		A	50
DC-11 L/R - 40 ms		x $I_e$	1.1
Breaking capacity			
AC-14 $\cos \varphi = 0.3$ 440 V		A	3
AC-15 $\cos \varphi = 0.3$ 220 V		A	3
DC-11 L/R - 40 ms		x $I_e$	1.1
Rated operational current	$I_e$	A	
AC--14			
440 V	$I_e$	A	3
AC-15			
220 V 230 V 240 V	$I_e$	A	3
DC-11			
Note			Making and breaking conditions to DC13, time constant as stated
L/R max. 15 ms		A	
24 V	$I_e$	A	1.5
L/R max. 50 ms		A	1.2
Conv. thermal current	$I_{th}$	A	6
Short-circuit rating without welding			
Note			When supplied directly from mains or transformer > 1000 VA
Max. fuse, make contacts		A gG/ gL	6
Max. fuse, break contacts		A gG/ gL	6

## Magnet systems

Rated operational voltage	$U_e$	V	
AC			24 - 240
DC			24 - 240
Voltage tolerance		x $U_c$	
Pick-up voltage		x $U_s$	
Min. pick-up voltage, AC operated		x $U_c$	0.85
Pick-up voltage AC operated, max.		x $U_c$	1.1

Pick-up voltage DC operated, min.		x U <sub>c</sub>	0.7
Max. pick-up voltage, DC operated		x U <sub>c</sub>	1.1
Power consumption			
Pick-up AC		VA	2
Sealing AC		VA	2
Pick-up DC		W	1.8
Sealing DC		W	1.8
Duty factor		% DF	100
Maximum operating frequency		Ops/ h	4000
Minimum command time			
AC		ms	50
DC		ms	30
Repetition accuracy (deviation)		%	 0.5
Recovery time (after 100% time delay)		ms	70

## Technical data ETIM 4.0

Number of outputs, delayed, N/O			0
Remote access possible			No
Number of outputs, non-delayed, N/O			0
Function off-delayed			No
Outputs, reversible delayed/non-delayed			YES
Type of electric connection			Screw connection
Number of outputs, non-delayed, N/C			0
Rated control voltage U <sub>s</sub> at DC		V	240
Clock function, starting with pulse, variable			No
Voltage type for actuation			AC/DC
Function flashing, starting with pulse, fixed time			No
Function pulse shaping			No
Rated control voltage U <sub>s</sub> at AC 50HZ		V	240
Time range		s	216000
Number of outputs, non-delayed, change-over contact			1
With semi-conductor output			No
Suitable only for remote control			No
Function flashing starting with pause, fixed time			No
Plug-in type on auxiliary contact block			No
Width		mm	60
With plug-in socket			No
Function fleeting contact on energization			No
Function star/delta			No
Rated control voltage U <sub>s</sub> at AC 60HZ		V	240
Function fleeting contact on de-energization			No
Function on-delayed			YES
Height		mm	60
Depth		mm	47
Function cyclic starting with pause, variable			No
Number of outputs, delayed, N/C			0
Number of outputs, delayed, changeover contact			1

## Characteristics

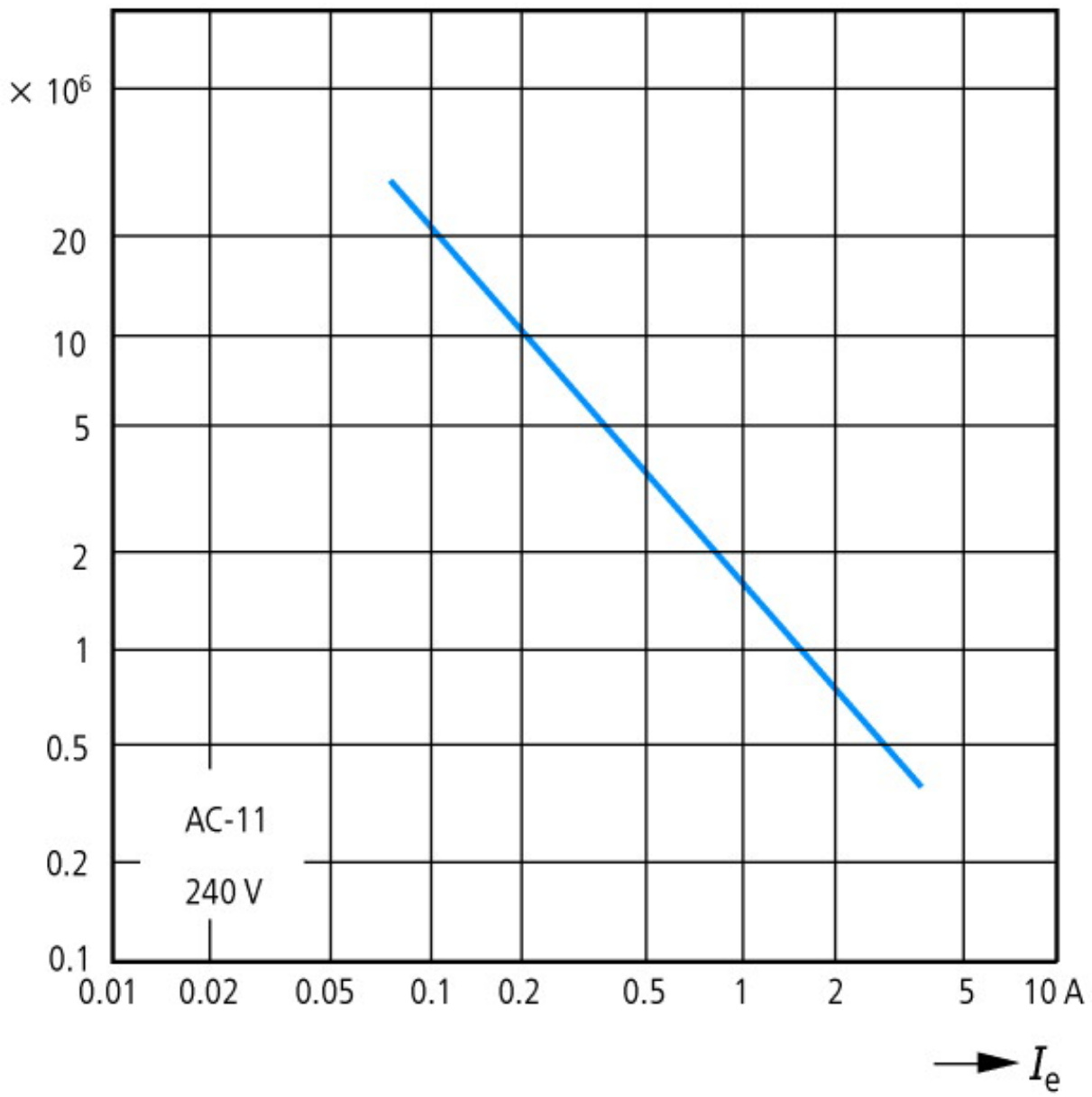

Component lifespan (operations)  
 $I_e$  = Rated operational current

### Dimensions

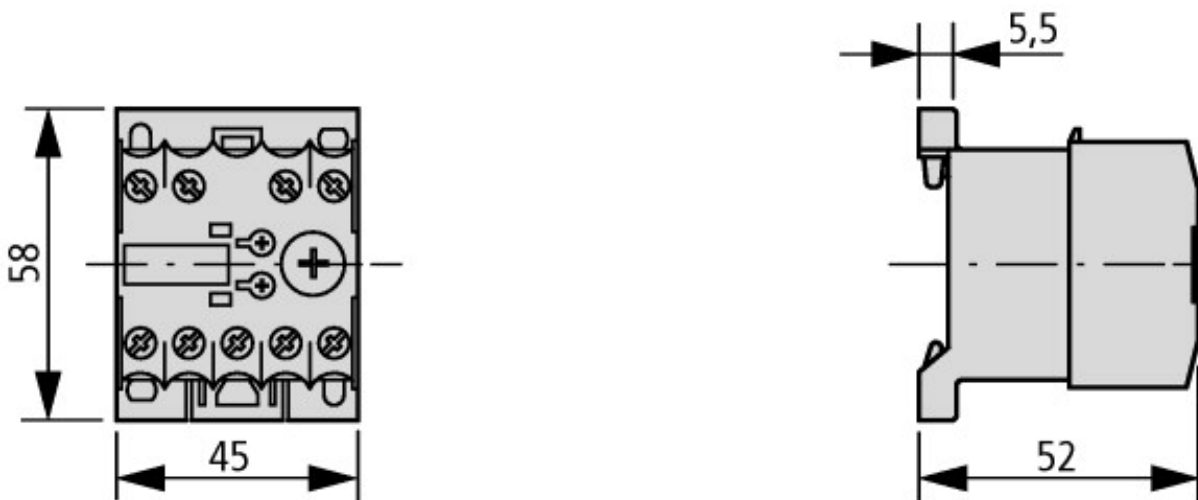

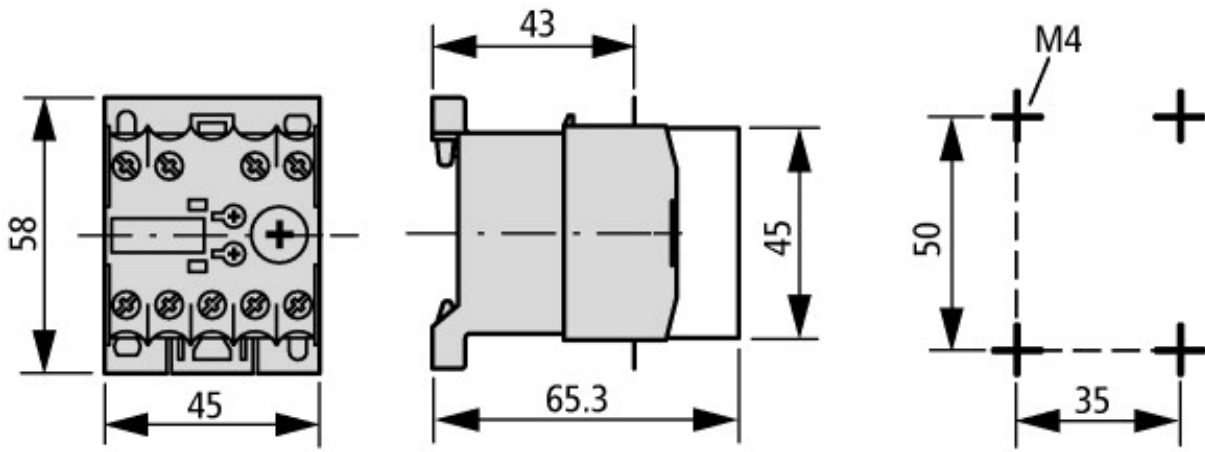

Electronic timing relay with sealable shroud  
DILET... + HDILE

### Additional product information (links)

#### IL04910003Z (AWA2527-1587) Solid-state timing relay

IL04910003Z (AWA2527-1587) Solid-state timing relay

[ftp://ftp.moeller.net/DOCUMENTATION/AWA\\_INSTRUCTIONS/IL04910003Z2010\\_10.pdf](ftp://ftp.moeller.net/DOCUMENTATION/AWA_INSTRUCTIONS/IL04910003Z2010_10.pdf)