

PrimaVision Xtreme for SON

HID-PV Xt 250 SON C2 208-277V

Highly reliable electronic drivers for SON lamps designed for saving energy via better light efficiency compared to magnetic drivers and for saving on maintenance costs thanks to a lifetime of up to 80000 hours and the integrated Lightning protection.

Product data

General Information	
Lamp type	SON
Number of lamps	1 piece/unit
Suitable for outdoor use	Yes
Number of products on MCB (16 A type B) (nom.)	11
Default lamp selected	SON250
Automatic restart	Yes
Operating and Electrical	
Input voltage	208-240-277 V
Input frequency	50-60 Hz
Minimum mains voltage operation (min.)	172 V
Operating frequency (nom.)	0.20 kHz
Power factor 100% load (nom.)	0.99
Ignition voltage (max.)	5 kV
Ignition switch-off time (nom.)	20 min
Mains voltage performance (AC)	188-305V
Mains voltage safety (AC)	160-305V
Earth leakage current (max.)	0.7 mA
Output peak voltage (max.)	250 V

Inrush current width	4 ms
Lamp power tolerance	-3%/+3%
Input current (nom.)	1.32 A
Inrush current peak (max.)	4 A

Wiring	
Cable capacity output wires mutual (max.)	1000 pF
Cable length from device to lamp	10 m
Wire strip length	10.0-11.0 mm
Ballast contact wire cross section	0.50-2.50 mm ²
Connector type	WAGO series 804

System characteristics	
Rated ballast-lamp power	250 W
Rated lamp power on SON	250 W
System power on SON	273 W
Lamp power on SON	250 W
Power loss on SON	23 W
Power loss on SON while dimming	13 W

PrimaVision Xtreme for SON

Temperature	
T ambient (max.)	50 °C
T ambient (min.)	-30 °C
T storage (max.)	50 °C
T storage (min.)	-30 °C
T case lifetime (nom.)	80 °C
T-Case switch off (min.)	92 °C

Controls and Dimming	
Programmable lamp settings	None
Pre-set integrated controls	None
Programmable dimming options	None
Run-up time before dimming	0 min
Fade-down rate	1.2 %/sec
Fade-up rate	13.3 %/sec
Control input protection	Yes (Basic insulation)
Regulating level	-

Mechanical and Housing	
Housing	C2

Approval and Application	
Surge protection (common/differential)	EN61547 (L-L 2kV, L-G 4kV), 10kV TIL kV
IP luminaire classification	34
Active temperature protection	Yes
Safety standard	IEC 607, 609, 926, 928 [No Standard for HID Lamp drivers exists. Requirements in these standards to be used if considered relevant for the product.]

Dimensional drawing

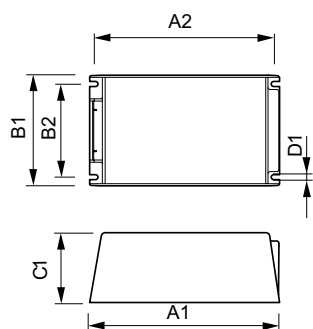

HID-PV Xt 250 SON C2 208-277V

Quality standard	ISO 9000:2000
Environmental standard	ISO 14001
Harmonic current emission standard	IEC 61000-3-2
Vibration standard	IEC 68-2-6 Fc (10-150Hz, 2G)
Bumps standard	IEC 68-2-29 Eb (10G/16ms)
Humidity standard	EN 61347-2-12 clause 11
Approval marks	F-Marking CE marking ENEC certificate VDE-EMV certificate
Humming and noise level	37 dB(A)

Product Data	
Full product code	871829122271200
Order product name	HID-PV Xt 250 SON C2 208-277V
EAN/UPC – product	8718291222712
Order code	22271200
Local Code	PVXT250SON
Numerator – quantity per pack	1
Numerator – packs per outer box	6
Material no. (12NC)	913700672866
Net weight (piece)	1.420 kg

Product	D1	C1	A1	A2	B1	B2
HID-PV Xt 250 SON C2 208-277V	4.8 mm	58.0 mm	169.0 mm	156.0 mm	65.0 mm	81.5 mm

PrimaVision Xtreme for SON

