

FRAMO 80 GOAL POST SUPPORT

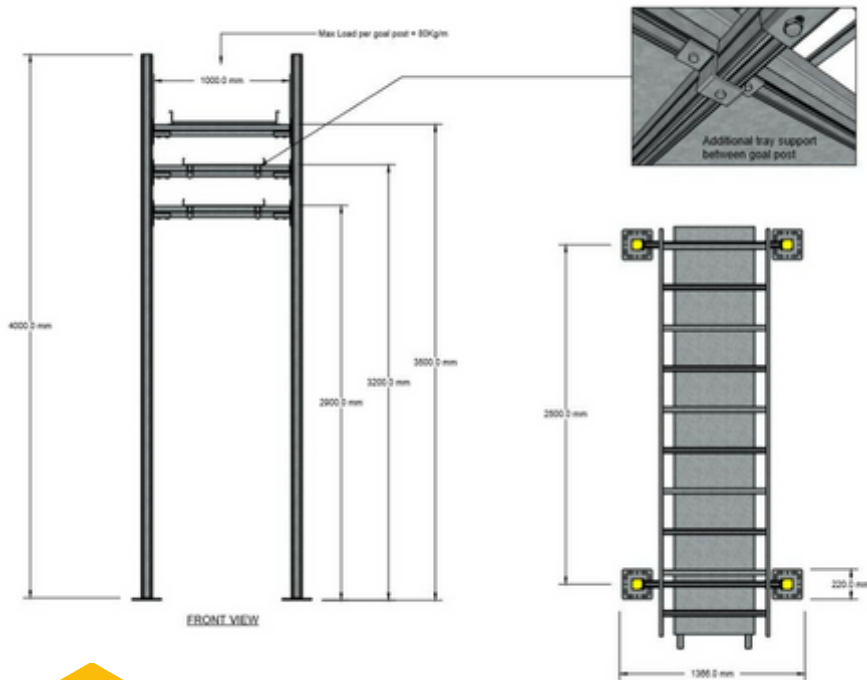

## Case Study: STOR Project

### Project Brief

MIDFIX received an enquiry to design and cost multi-level containment brackets to support HV and LV electrical services at high level, independent of the plant and equipment but allowing personnel access for regular maintenance.

### Solution

In this instance, we selected the Sikla Framo product as this provided the perfect solution for securing heavy cable ladder, pipework and trays at height. Our design engineering experts created the full design with load calculations. Once the designs were approved, this was handed over to our prefabrication specialists to assemble.

# 3

days to design, fabricate  
and deliver

